



SM Motorenteile GmbH

Asperg / Stuttgart / Germany

phone : +49 / (0)7141 / 2047-0

fax : +49 / (0)7141 / 2047-16

e-mail : info@sm-original-germany.com

<http://www.sm-original-germany.com>

Alleenstr. 70 / D-71679 Asperg



Don't be irritated



Don't buy imitated

Imitation secured packing supplied by us for all products.



Simply to be checked with a lens key from us.



Ask your dealer or importer !

www.sm-original-germany.com



Visible text: O/E SUPPLIER SINCE 1973

KREUZGELENKE
UNIVERSAL JOINTS
JOINT DE CARDAN
CRUZETA DE CARDAN

Inhaltsverzeichnis Table of contents Table des matières Indice	Seite Page Page Página
---	---

<p>Anleitung zum Katalog / How to use the catalogue Mode d'emploi du catalogue / Empleo del catálogo</p>	<p>I - II</p>
<p>Inhaltsverzeichnis nach Maß D / Table of contents in order of measurement D Index par mesures D / Indice por D</p>	<p>III</p>
<p>Wichtiger Hinweis Important notice Note importante Nota importante</p>	<p>VI</p>
<p>Vergleichsnummern Liste : GKN → SM Cross reference list : GKN → SM Liste d'équivalences : GKN → SM Lista de intercambios : GKN → SM</p>	<p>29</p>
<p>Vergleichsnummern Liste : OEM REF. → SM Cross reference list : OEM REF. → SM Liste d'équivalences : OEM REF. → SM Lista de intercambios : OEM REF. → SM</p>	<p>30 - 33</p>
<p>Vergleichsnummern Liste : SPICER → SM Cross reference list : SPICER → SM Liste d'équivalences : SPICER → SM Lista de intercambios : SPICER → SM</p>	<p>34</p>
<p>Vergleichsnummern Liste : TRW → SM Cross reference list : TRW → SM Liste d'équivalences : TRW → SM Lista de intercambios : TRW → SM</p>	<p>35</p>
<p>Vergleichsnummern Liste : UC → SM Cross reference list : UC → SM Liste d'équivalences : UC → SM Lista de intercambios : UC → SM</p>	<p>36</p>

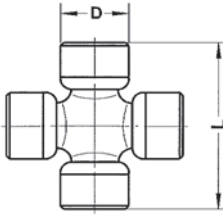

Anleitung zum Katalog How to use the catalogue Mode d'emploi du catalogue Empleo del catálogo

①		② SM Ref.: 39753 ③ Cross Ref.					
		U753 U932 19394 20296 5-1519X					
④	D	L	F	R	S	T	⑤ Lubricator
	45,00	120,40	-	-	-	-	2
APPLICATION							OE Ref.:
MERCEDES – BENZ							
Truck	1517-1519 L- LA- LAK- LAS - LK- LP- LPK- LPS 1813- 1817- 1819- 1919 AK-K-s 1921 - 1924 - 1926 L - LK - LS - LAK - LAS - LK - LS 2024 - 2026 - 2032 - 2219 - LPS - S - LS - K - KO - L - LP - LPK 2220 - 2223 LP - 2224 B - K - LP - LPB - LPK - LPS - S 2226 - 2228 - 2232 - 2233 L - LP - LPB - LPK - LS 2448 - 2624 L - LA - LAK - 2626 - 2628 A - AB - AK – AS					304 410 0031 304 410 0031 304 410 0031 304 410 0031 304 410 0031 304 410 0031 304 410 0031 304 410 0031 317 410 0031	
⑥	⑦					⑧	

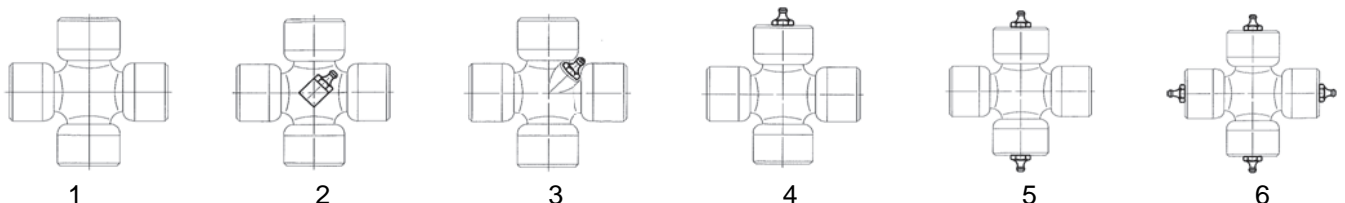
- ① Graphische Darstellung / picture / schéma de produit / representación gráfica
- ② **39753 = SM** Teilenummer / **SM** reference / numéro de référence **SM** / número de referencia **SM**
- ③ Vergleichsnummern / Cross references / equivalences / intercambios
- ④ Kreuzgelenkmaße / measurements of universal joint / mesures des joint de cardan / medidas de cruzeta de cardan
- ⑤ Schmiernippel Typen / lubricator types / types de plat / pezones lubricantes

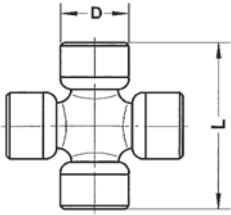

Anleitung zum Katalog How to use the catalogue Mode d'emploi du catalogue Empleo del catálogo

①		② SM Ref.: 39753 ③ Cross Ref.	 U753 U932 19394 20296 5-1519X				
④	D	L	F	R	S	T	⑤ Nipple Type
	45,00	120,40	-	-	-	-	2
APPLICATION							OE Ref.:
MERCEDES – BENZ							
⑥	Truck	1517-1519 L- LA- LAK- LAS - LK- LP- LPK- LPS 1813- 1817- 1819- 1919 AK-K-s 1921 - 1924 - 1926 L - LK - LS - LAK - LAS - LK - LS 2024 - 2026 - 2032 - 2219 - LPS - S - LS - K - KO - L - LP - LPK 2220 - 2223 LP - 2224 B - K - LP - LPB - LPK - LPS - S 2226 - 2228 - 2232 - 2233 L - LP - LPB - LPK - LS 2448 - 2624 L - LA - LAK - 2626 - 2628 A - AB - AK - AS	⑦	304 410 0031 304 410 0031 304 410 0031 304 410 0031 304 410 0031 304 410 0031 304 410 0031 317 410 0031	⑧		

- ⑥ Hersteller / Typ
Manufacturer / Make
Constructeurs /Marque
Fabricante /Tipo
- ⑦ Typ / Motor / Fahrzeugdetails
Make / engine / vehicle details
Marque / moteur / descriptions
Tipo / motor / aplicación
- ⑧ Nummer des Erstausrüstungskreuzgelenks für Identifikationszwecke /
Manufacture's original part no. for identification only /
Numéro de référence d'usine de la nipple, pour identification /
Número de referencia de fabricante de equipo original, para identificación

Inhaltsverzeichnis nach Maß D
Table of contents of measurement D
Index par mesures D
Indice por D

KREUZGELENKE / UNIVERSAL JOINTS / JOINT DE CARDAN / CRUZETA DE CARDAN

D	SM Ref.	Seite / Page / Page / Página
23,75	392899	1
24,06	397284	1
26,97	39110	2 – 3
26,97	39100	3 – 4
27,00	39178	4
30,15	39220	5
31,00	39325	5
35,00	39743	6
38,00	39730	6
39,63	39350	7 – 9
41,30	39090	9
42,00	39747	10
44,00	39380	10
44,00	39384	11
45,00	39753	11
47,62	39400	12 – 14
47,62	39429	14
48,00	39767	15
48,00	39765	16
48,00	39948	16
49,20	39958	17
50,00	39381	17
50,00	39388	17
52,00	39756	18 – 19
52,00	39909	20
53,00	39761	20
55,00	39170	21
57,00	39813	21 – 22
57,00	39763	23
57,00	39990	23
57,00	39949	24
57,00	39954	24
59,00	39918	24
60,00	39250	25
65,00	39982	25
65,00	39924	26
68,00	39462	26
68,00	39993	26

KUPPLUNGSUSRÜCKLAGER



CLUTCH RELEASE BEARINGS WITH SUPPORT

ROULEMENT D'EMBRAYAGE AVEC SUPPORT

RODAMIENTOS DE EMBRAGUE CON SOPORTE

Inhaltsverzeichnis	Seite
Table of contents	Page
Table des matières	Page
Indice	Página
Anleitung zum Katalog / How to use the catalogue Mode d'emploi du catalogue / Empleo del catálogo	IV
Inhaltsverzeichnis nach Maß D / Table of contents in order of measurement D Index par mesures D / Indice por D	V
Wichtiger Hinweis Important notice Note importante Nota importante	VI
Vergleichsnummern Liste : LUK REF. → SM Cross reference list : LUK REF. → SM Liste d'équivalences : LUK REF. → SM Lista de intercambios : LUK REF. → SM	57
Vergleichsnummern Liste : NWO REF. → SM Cross reference list : NWO REF. → SM Liste d'équivalences : NWO REF. → SM Lista de intercambios : NWO REF. → SM	58
Vergleichsnummern Liste : OEM REF. → SM Cross reference list : OEM REF. → SM Liste d'équivalences : OEM REF. → SM Lista de intercambios : OEM REF. → SM	59 - 60
Vergleichsnummern Liste : SACHS REF. → SM Cross reference list : SACHS REF. → SM Liste d'équivalences : SACHS REF. → SM Lista de intercambios : SACHS REF. → SM	61

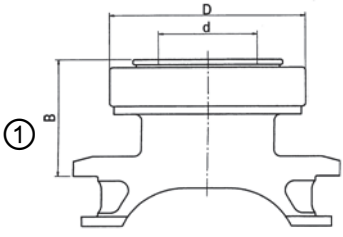
Anleitung zum Katalog How to use the catalogue Mode d'emploi du catalogue Empleo del catálogo

	SM Ref.: 381322	Cross Ref.: 3151 105 141 500 0271 20 RDL 1322	
			
④	D 115,00	B 72,00	d 66,10
VOLVO		APPLICATION	OE Ref.:
⑤	B 51 - B 59 F 10 F 88 F 89 FB – series G – series	⑥	1527695 267158 348842 8112139
			⑦

- ① Graphische Darstellung / picture / schéma de produit / representación gráfica
- ② **381322 = SM** Teilenummer / **SM** reference / numéro de référence **SM** / número de referencia **SM**
- ③ Vergleichsnummern / Cross references / equivalences / intercambios
- ④ Kupplungsausrücklagermaße / measurements of clutch release bearing / mesures des roulement d'embrayage / medidas de rodamientos de embrague
- ⑤ Hersteller / Typ
 Manufacturer / Make
 Constructeurs / Marque
 Fabricante / Tipo
- ⑥ Typ / Motor / Fahrzeugdetails
 Make / engine / vehicle details
 Marque / moteur / descriptions
 Tipo / motor / aplicación
- ⑦ Nummer des Erstausrüstungskreuzgelenks für Identifikationszwecke /
 Manufacture's original part no. for identification only /
 Numéro de référence d'usine de la nipple, pour identification /
 Número de referencia de fabricante de equipo original, para identificación

Inhaltsverzeichnis nach Maß D
Table of contents of measurement D
Index par mesures D
Indice por D

**KUPPLUNGSUSRÜCKLAGER / CLUTCH RELEASE BEARINGS WITH SUPPORT /
ROULEMENT D'EMBRAYAGE AVEC SUPPORT / RODAMIENTOS DE EMBRAGUE
CON SOPORTE**

D	SM Ref.	Seite / Page / Page / Página
62,50	381010C	39 – 40
67,90	381506	40 – 41
81,60	381312	42
92,00	381305	43
100,00	381397	44
110,00	381320	44 – 45
110,00	381328	45
110,00	381307	46
115,00	381316L	47
115,00	381316S	47
115,00	381318	48
115,00	381322	48
116,60	381015S	49
124,00	383901	49
124,00	385101	50
126,60	381319	50
126,60	381325	51
126,60	381329	51
126,60	381332	52
126,60	381352	52
126,60	381356	53
	381514	53

Wichtiger Hinweis / important notice / note importante / nota importante

SM und das SM Logo sind eingetragene Warenzeichen von SM Motorenteile GmbH / Asperg / Deutschland.

Alle in diesem Katalog aufgeführten Angaben wurden mit größter Sorgfalt zusammengestellt und kontrolliert. Wir haften nicht für die Folgen etwaiger Irrtümer und behalten uns technische Änderungen vor.

Die im Katalog aufgeführten Originalnummern dienen lediglich zu Vergleichszwecken.

Die im Katalog aufgeführten Teile werden nach unseren Verpackungseinheiten ausgeliefert. Die jeweiligen Verpackungseinheiten entnehmen Sie bitte aus unserer aktuellen Preisliste.

Aufträge werden auf der Grundlage unserer „Allgemeinen Geschäftsbedingungen“ angenommen.

SM and the SM logo are registered trademarks of SM Motorenteile GmbH / Asperg / Germany.

All items listed in this catalogue have been checked very carefully. Nevertheless we are not liable for any mistake and reserve us the right to make technical changes.

The original part references listed in this catalogue are only for identification.

The items listed in this catalogue will be delivered in our packing units. These you will find in our current price list.

Orders are subject to our common delivery terms.

SM et son logo sont des marques déposées de la société SM Motorenteile GmbH / Asperg / Allemagne.

Toutes les informations de ce catalogue ont été établies et contrôlées avec les plus grands soins. Nous ne nous portons pas garants des conséquences d'éventuelles erreurs et nous nous réservons le droit d'éventuelles modifications techniques.

Les numéros de référence indiqués dans ce catalogue ne servent que d'équivalence.

Les pièces de notre catalogue seront livrées selon nos unités de conditionnement mentionnées dans le tarif en vigueur.

Les commandes seront enregistrées selon nos conditions générales de vente.

SM y el logotipo de SM son marcas comerciales registradas de SM Motorenteile GmbH / Asperg / Alemania.

Toda la información depositada en este catálogo ha sido revisada con el mayor cuidado y control posible. Sin embargo, no nos hacemos responsables de cualquier error y nos reservamos el derecho de modificaciones técnicas.

Las referencias a números de piezas originales que figuran en este catálogo sirven solo para propósitos de comparación y/o identificación.

Las piezas que figuran en el catálogo son suministrados en nuestras unidades de embalaje, cuya referencia se encuentra en nuestra lista de precios.

Los pedidos se registran de acuerdo con nuestras condiciones generales de venta y están sujetos a nuestros plazos de entrega comunes.

KREUZGELENKE
UNIVERSAL JOINTS
JOINT DE CARDAN
CRUZETA DE CARDAN

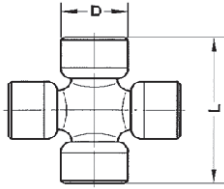

SM Ref.: 392899

Cross Ref.:



D	L	F	R	S	T	Lubricator
23,75	61,50	-	-	-	-	-

APPLICATION

OE Ref.:

LADA		
	U 40	

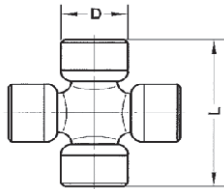

SM Ref.: 397284

Cross Ref.:

U728/4
18725

for stake securing



D	L	F	R	S	T	Lubricator
24,06	74,90	-	-	-	-	1

APPLICATION

OE Ref.:

MERCEDES - BENZ		
Car	200 - 200D - 200E - 200TE 207D - 209D - 210 - 220 - 220D 230 - 230C - 230E - 230CE - 230TE - 230S - 230.4 - 230.6 - 240D 250 - 250C - 250CE 260SE-W126 280 - 280C - 280CE - 280E - 280S - 280SE - 280SEL - 280SLC 300D - 300D 4 Matic - 300SEL - 300SE - 300SL - 300SD - 300SDL 307D-309D-310 350SE - 350SEL - 350SL - 350SLC 380SE - 380SEC - 380SL 420 SEC/SL - 420 SE/SEL - 420SL 450SE - 450SEL - 450SL - 450SLC 500 SEC/SL - 500 SE/SEL - 500SL 560 SEC/SL - 560SEL - 560SL	601 410 0231

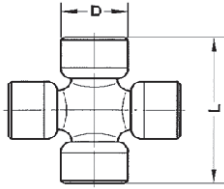

SM Ref.: 39110

Cross Ref.:

U110 5-94X
 13872
 18110
 20023
 5-4X



D 26,97	L 74,61	F -	R -	S -	T -	Lubricator 3
-------------------	-------------------	---------------	---------------	---------------	---------------	------------------------

APPLICATION		OE Ref.:
ALFA - ROMEO		9813973
BEDFORD		7190326
BERLIET Truck		943541019
CITROEN		110310120
DODGE Commer Walk Commer	KAD, KAH, KAV, KCH, KCV PA, PB	
FORD - GB		105E-7039 213E-4635A 2400E-4635A 3010E-4635A 404E-4635A EDA-7039
FERRARI 330 365	GTC Coupe , GTS Spider	Propshaft
FIAT Car	1103 1400- 1900	4552008 4556519 876045 882320 883236 967265
MASERATI All models		Propshaft
MATRA Jet	5,6	
RENAULT Truck	90 B6 380 KE - 400 KE JK50- JK60- JK65 SG 1 - SG 2 - SG 3 - SG 4	9 43 541 019 9 43 541 019 50 00 243 236 50 00 243 236
ROVER - LAND ROVER		512544 243023 242521 243203 541858

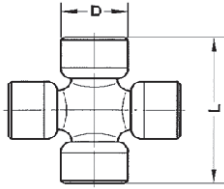

SM Ref.: 39110

Cross Ref.:

U110 5-94X
 13872
 18110
 20023
 5-4X



D 26,97	L 74,61	F -	R -	S -	T -	Lubricator 3
-------------------	-------------------	---------------	---------------	---------------	---------------	------------------------

APPLICATION

OE Ref.:

SAVIEM		
Truck & Van		50 00 243 236 23232051 9 81 397 300
TALBOT FRANCE		
160, 180	Automatic	Front propshaft
VOLVO		
142	B20A, B20B, B20D, B20F (from chassis 393950)	Rear propshaft
144	B20A, B20B, B20D, B20F (from chassis 393950)	Rear propshaft
145	B20A, B20B, B20D, B20F (from chassis 210050)	Rear propshaft
242		Rear propshaft
244	B20A, B20F, B21A	Rear propshaft
245	B20A, B20F, B21A	Rear propshaft
740 / 760		
Truck	142B20 - 144B20 - 145B20 - 242B20 - 244B20	383472 38403

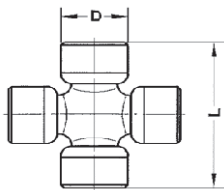

SM Ref.: 39100

Cross Ref.:

U100 5-12X / 5-13X
 10101 /18100 5-21X / 5-5X
 20024 5-63X / 5-6X
 5-113X / 5-11X 5-71X
 5-120X / 5-121X



D 26,97	L 81,75	F -	R -	S -	T -	Lubricator 3
-------------------	-------------------	---------------	---------------	---------------	---------------	------------------------

APPLICATION

OE Ref.:

ALFA ROMEO		
F20		
BEDFORD		
		8845370
BUICK		
Appollo, Seabird Skyhawk, Skylark		
JEEP		
Most models	60 - 78	
MACK		
		201SJ-22

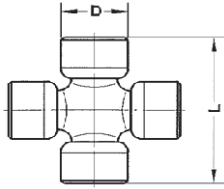

SM Ref.: 39100

Cross Ref.:

U100 5-12X / 5-13X
 10101 /18100 5-21X / 5-5X
 20024 5-63X / 5-6X
 5-113X / 5-11X 5-71X
 5-120X / 5-121X



D 26,97	L 81,75	F -	R -	S -	T -	Lubricator 3
-------------------	-------------------	---------------	---------------	---------------	---------------	------------------------

APPLICATION

OE Ref.:

MITSUBISHI

Debonea

A 30

J-906926/9
 JA-7042
 K5-21X
 MJ-906929

PONTIAC

Firebird
 Phoenix
 Sunbird
 Ventura

70-74
 78-ON
 76-80
 71 -76

ROVER - LAND ROVER

OTHER MODELS

504439
 515723
 542544
 601557

VOLVO

142
 144
 145
 164
 264 , 265

B20E
 B20E
 B20E

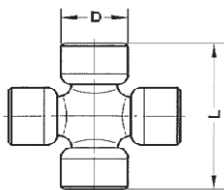

SM Ref.: 39178

Cross Ref.:

U178
 18178



for stake securing

D 27,00	L 80,00	F -	R -	S -	T -	Lubricator 1
-------------------	-------------------	---------------	---------------	---------------	---------------	------------------------

APPLICATION

OE Ref.:

VOLKSWAGEN

LT

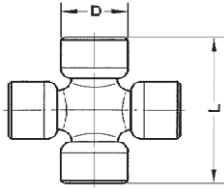

SM Ref.: 39220

Cross Ref.:

U220 5-178X / 5-18X
 18220 5-480X / 5-617X
 20054 / 20140 5-627X / 5-78X
 20190 / 20337 5-7X / 5-9X
 5-143X / 5174X

for stake securing



D	L	F	R	S	T	Lubricator
30,15	92,03	-	-	-	-	3

APPLICATION

OE Ref.:

DENNIS		693864
DODGE		
Bantam Commer Walk Van	FB KAB, KAL, KCB, KCL	with 4.5" round
FERRARI		
330	GTC Coupe , GTS Spider	Rear halfshaft
FORD - GB		
		01T-7039
MACK		
		201SJ-11 201SJ-26
MASERATI		
All models		Rear halfshaft
PONTIAC		
Bonneville Catalina Firebird	83-ON 83-ON 82-ON	with external cerclip joints
Grand Prix Parisienne	83-ON 83-ON	

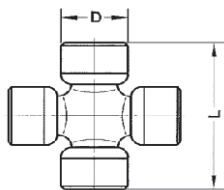

SM Ref.: 39325

Cross Ref.:

U325
17173

for stake securing



D	L	F	R	S	T	Lubricator
31,00	88,20	-	-	-	-	4

APPLICATION

OE Ref.:

MERCEDES - BENZ		
	G-Class	

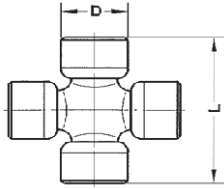

SM Ref.: 39743

Cross Ref.:

U743



D	L	F	R	S	T	Lubricator
35,00	96,80	-	-	-	-	2

APPLICATION

OE Ref.:

DAF		OE Ref.:
Truck	F500 - F700 - F800 - F900 - FI 100 - FL 300	542635
	FA-FM-FT1600 DF	542635
	FA - FT1 400DD - FM 1600 - FA1 600 DF - FA1 600 DTD	542635
	FAV - 1800DT (4x4)	542635
MERCEDES - BENZ		OE Ref.:
		030 410 0431
		030 410 1831
STEYR		OE Ref.:
	Various trucks	292420713

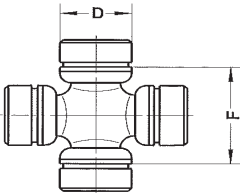

SM Ref.: 39730

Cross Ref.:

U730

18730

20417

5-1506X



D	L	F	R	S	T	Lubricator
38,00	-	56,50	-	-	-	2

APPLICATION

OE Ref.:

MERCEDES - BENZ		OE Ref.:
Truck	302 (all models)	385 410 0231
	309D/313/382/386/389	385 410 0231
	309B - 309D	385 410 0231
	323/710 L-LA-LAF-LAK	302 410 0031
	323/710 LAS-LF-LK	302 410 0031
	328-328/911 L - LA - LAF - LAK - LAS - LF-LK - LKO - LS-LAKO	302 410 0031
	408DG - L408DG	385 410 0231
	508DG - L - LF - LK - LKO	385 410 0231
	608D - L - LK - LP - LPK - LPKF - LPKO - LPL	385 410 0231
	808 - 809 LP - LPK - LPKF - LPL - LPO	385 410 0231
	810-811 - 813-LP-LPF-LPK-LPKO-LPS	385 410 0231
	911B- L - LA- LAF- LAK- LAKO- LAO- LAS	385 410 0231
	913 LP-LPK-LPL-LPS	385 410 0231
	1013 - 1013A - AK - K - KO - LP - LPF - LPKO - LPS	385 410 0231
	1017A-AF-AS-F-K-KO-LS	385 410 0231
	11 13B - L - LA - LAF - LAK - LAKO - LAS - LPK	385 410 0231
	1213 A - AK - AKO - AS - K - KU - LP - LPK - LPKO	385 410 0231
	1216 - 1317 - 1319 LP - LPK - LPKO - LPS	385 410 0231
	1217- 1219- 1313- 1413-A-AF-L - LA -LAK	385 410 0231
	1417 - 1418 - 1419 - 1420 A - AK - L - LK - F	385 410 0231
	1513 L - LA - LAK - LAKO - LK - LKO - LP - LPS	385 410 0231
	1813- 1817- 1819- 1919 AK-K-s	385 410 0231
		312 411 1231
		310 410 0031
		312 411 1331
		322 411 0031
		322 411 0131

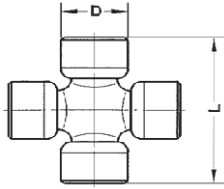

SM Ref.: 39350

Cross Ref.:

U350
18350



D	L	F	R	S	T	Lubricator
39,63	115,81	-	-	-	-	3

APPLICATION		OE Ref.:
ALFA ROMEO		
Autocano	1 AS	01735-25704
BEDFORD		
Truck	CFJ - CFJNL - C001 - COQ2 - C003 - MN3 - TK/EFM2 - EFM3 - EFN - EFN3 - EFRA - EFR3 - EFR4 - EFR6 - FJM2 - EJM3 - ENJ3 - EJRA - EJR1 - EJR3 - EJR4 - EJR6 - EJQ8 - EPRA - EPR1 - ERT2 - ERT3 - ERT4 - ERT6 - ERT8W - EPR3 - EPR4 - EPR6 - EPR7 - EPR8-ERT2-ERT3-ERT4-ERT6	7088368 7088370 7178684 91021384
BERLIET		
Truck		9 43 541 500 3400021 3400040
CITROEN		
Truck & Van	T45, T46, T55 600, 700, 800, 850	603710810
DAF		
Truck	FA - FT1200DA - T1300DA - T1600DF - A1600DD (4x4)	316340
DENNIS		
Most Trucks	59 - 82	686704
FIAT / IVECO		
Bus	314.3	9105823
Truck	100.13 - 109.14 - 110NC -110.14 - 110NR - 110NT 115.14- 115.17- 120.13- 120.14 130NC-130NR-130NT-130M.14-135.14-135.17-140.14-150.14 175.17 180NT-180NTS 300PC - 300PT 65 PC - 75 PC - 70.13 - 79.14 80NC - 80,13 691T 697N 90 M9.0 - 90NC - 90 PC - 90.13 - A.90.13 - A90.14 - 95.14	4679190 4679190 4679190 9105823 9105823 4679190 8120185 9932700 4679796 4679190 9105823 9105823 4679190 4679190 4641105 0467 9120 0598 5281 0993 2700

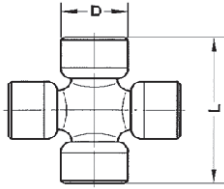

SM Ref.: 39350

Cross Ref.:

U350
18350



D 39,63	L 115,81	F -	R -	S -	T -	Lubricator 3
-------------------	--------------------	---------------	---------------	---------------	---------------	------------------------

APPLICATION

OE Ref.:

SAVIEM						
Truck & Van						50 00 242 492 77 01 005 432 8 70 550 300
SCANIA						
Truck	L 36 - 50					750610 47804 77187
SEDDON ATKINSON						
	200 Series					
VOLVO						
Truck	F84 - F85 - N84 - 854 L420 - L425 - L430 - L435 L465 - L475 - L485 F609 - F61 0 - F61 1 - F613 - F614 - TF614					36590 6852612 6852612 6621656 6876177 83453

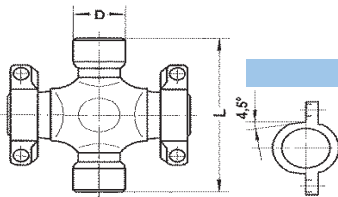

SM Ref.: 39090

Cross Ref.:

090X



D 41,30	L 126,00	F -	R -	S -	T -	Lubricator -
-------------------	--------------------	---------------	---------------	---------------	---------------	------------------------

APPLICATION

OE Ref.:

MERCEDES - BENZ						

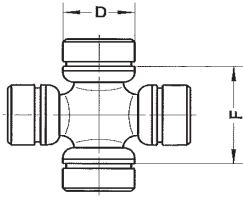
**SM Ref.: 39747****Cross Ref.:**U747
10059

D	L	F	R	S	T	Lubricator
42,00	-	66,40	-	-	-	2

APPLICATION**OE Ref.:****MERCEDES - BENZ**

APPLICATION	OE Ref.:
MERCEDES - BENZ	
Truck	
302.213/218/219/233/238/243/248/283 /288/293/297	385 410 0131
317/201 /202/203/206/216/221/226	385 410 0131
1017A-AF-AS-F-K-KO-LS	385 410 0131
1217 - 1219-1313-1413-A-AF-L-LA-LAK	385 410 0131
1417 - 1418 - 1419 - 1420 A - AK - L - LK - F	385 410 0131
1513 L - LA - LAK - LAKO - LK - LKO - LP - LPS	385 410 0131
1517 -1519 L - LA - LAK - LAS - LK - LP - LPK - LPS	385 410 0131
1613-1613 K - 1619 A-AK-K-KO-L-LPKO-S	385 410 0131
1813- 1817- 1819- 1919 AK-K-s	385 410 0131
2024 - 2026 - 2032 - 2219 - LPS - S - LS - K - KO - L - LP - LPK	385 410 0131
	317 410 0131
	337 410 0031
	337 410 0531
	354 410 0131

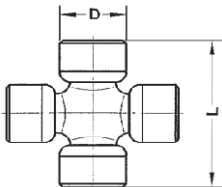
**SM Ref.: 39380****Cross Ref.:**U380
18380

D	L	F	R	S	T	Lubricator
44,00	126,00	-	-	-	-	2

APPLICATION**OE Ref.:****VOLVO**

APPLICATION	OE Ref.:
VOLVO	
Truck	
F7 - N7 - TN7 - TF7 (6x4)	232458
F86 - N86 - F87 - F89 - FB86 - G89 - NB86	231626
F88 -FB88 - N88 - NB88 - F89 - G89 (6x4 - 6x6)	231626
	7231265

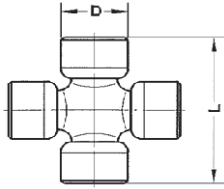

SM Ref.: 39384

Cross Ref.:

U384
10062



D 44,00	L 149,00	F -	R -	S -	T -	Lubricator 3
-------------------	--------------------	---------------	---------------	---------------	---------------	------------------------

APPLICATION

OE Ref.:

SCANIA		OE Ref.:
Truck	L - LB 140 - 141 P (4x2) L - BS 140 (6x2) L - LB 140 - 141 P (4x2) L - BS 140 (6x2) L - LB 85 - 86 - 110 (4x2) - 111 (4x2) - L 86P - PA LBT 110 -111 - 140 - 141 P (6x4) - T60 - T70 LS-LBS 85-86P-110(4x2)- 111 (6x2) T60, TA60, T62	750612 297563 178258 750612 550612

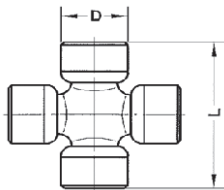

SM Ref.: 39753

Cross Ref.:

U753
U932
19394
20296
5-1519X



D 45,00	L 120,40	F -	R -	S -	T -	Lubricator 2
-------------------	--------------------	---------------	---------------	---------------	---------------	------------------------

APPLICATION

OE Ref.:

MERCEDES - BENZ		OE Ref.:
Truck	1517-1519 L - LA- LAK- LAS - LK- LP- LPK- LPS 1813- 1817- 1819- 1919 AK-K-s 1921 - 1924 - 1926 L - LK - LS - LAK - LAS - LK - LS 2024 - 2026 - 2032 - 2219 - LPS - S - LS - K - KO - L - LP - LPK 2220 - 2223 LP - 2224 B - K - LP - LPB - LPK - LPS - S 2226 - 2228 - 2232 - 2233 L - LP - LPB - LPK - LS 2448 - 2624 L - LA - LAK - 2626 - 2628 A - AB - AK - AS	304 410 0031 304 410 0031 304 410 0031 304 410 0031 304 410 0031 304 410 0031 304 410 0031 317 410 0031

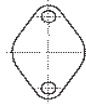
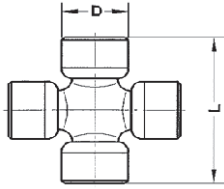

SM Ref.: 39400

Cross Ref.:

U400 5-16X
 18400 5-279-2X
 20104 5-279X
 20134
 5-116X



D 47,62	L 134,82	F -	R -	S -	T -	Lubricator 3
-------------------	--------------------	---------------	---------------	---------------	---------------	------------------------

APPLICATION **OE Ref.:**

ALFA ROMEO		
Autocano	1 AS	01735-25704

BEDFORD		
Truck	KM/ERV1 - ERV2 - ERV3 - ERV5 - ERV6 - ERV7 - ERV8 - ERV9 - TK/ERT8W - HRX	7206809

BERLIET		
Truck		943541600

DENNIS		
Most Single	-83	1305151

FIAT / IVECO		
Bus	306	9981618
	370.20	9981618
Truck	421A-421AL	9981618
	421A-421AL	8190503
	421AL	9981618
	130 NR20 - 130 NT20 - 140.20	4656653
	150NC17 - 150NC20 - 150NT20 - 150 - 150.16A - 150.17	4686738
	159.17 - 159NC17 - 159.20 - 159.20R - 159NC20 - 159NR20	9981618
	160.16A- 160.16AR	8190503
	168M.14- 168M.16	9981618
175.24	8190503	
		4699481

FORD (GB) - (D)		
Transit	D700 Turbo Diesel	2002E4635A
	D800/Turbo - Turbo Diesel - DT800	2002E4635A
	D900 - D1211.1311 - 1314 - DT1400 - 1414 - 1614 - 1618	

LEYLAND		
Beaver	(6x4)	
Chieftain	CH4012T - 4013L - N - T - XL (all models)	
Clydesdale	ECD4014L - N - T - 4114 L-N-T (all models)	
Comet	SWB (4x2) - LWB (6x4) - Mastiff MS1600	
Eland	EL4014L-N-T(all models)	
Lynx	(4x2)	
Mammouth	(all models)	
Mammouth	G6RAW - TG6RB - 246RAB - 248RAD	
Marshall	2TGM6RT (all models)	
Mercury	TGM4R - G2R - 3TGM/1 - 2 - 3 - 4	
Reiver	ERE4021 L - N/4021 T - Y (all models)	
	TFA/B81 -TM300	

MACK		
Truck	B61 S - SX - F785ST (6x4) - N R 14 - R607S - SA - SX - R609S	201SJ-25 201SJ-14 2104-5279X

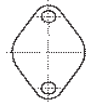
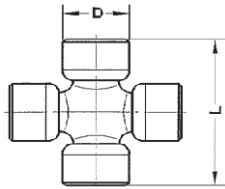

SM Ref.: 39400

Cross Ref.:

U400 5-16X
 18400 5-279-2X
 20104 5-279X
 20134
 5-116X



D	L	F	R	S	T	Lubricator
47,62	134,82	-	-	-	-	3

APPLICATION

OE Ref.:

RVI		
Truck	150 BII	9 43 541 600
	150 B13R - 150 TB19 -150 TB20 -150TB21	9 43 541 600
	C210.19-C210.19T	9 43 541 600
	G 170.15 - G 170.16 - G 170.16D - G 210 - G 230	9 43 541 600
	GB 131 -GB231	9 43 541 600
	GBH 260 - GBH 280 (6x6)	9 43 541 600
	GBO 15M3(6x4)	9 43 541 600
	GBU 15	9 43 541 600
	GC 190 - GC 190/2 - GC 191 - GC 230 - GC 231	9 43 541 600
	GCK 8AR - GCK 160A - GCK 160B	9 43 541 600
	GF 190- GF 190/2 - GF 191 - GF 231	9 43 541 600
	GLC8M2-GLC8M3	9 43 541 600
	GLM 10(6x4)	9 43 541 600
	GLM 10(6x4)	9 43 541 999
	GLR 8M3 - GLR 8R3 - GLR 160 - GLR 160A - GLR 160B - GLR 160MC	9 43 541 600
	GLR 190	9 43 541 600
	GLR 230	9 43 541 600
	GR 190-GR 190/2-GR 191	9 43 541 600
	GR 230-GR 231	9 43 541 600
	GR 255	9 43 541 600
	GRH 230 (6x4) - GRH 235 (6x4)	9 43 541 600
	HB 15 - HB 17 - HB 19 - HB 26 - HB 26T - HF 15 - HF 17 - HF 19T -	50 00 559 360
	HF 26V (6x4) - HF 26VR (6x4)	9 43 541 600
	HM 15-HM 17-HM 19-HM 26	50 00 559 360
	HN 19-HN 26	50 00 559 360
	JP 13A	50 00 599 360
	JR 19 - JR 19A - JR 19B - JR 21 - JR 21A - JR 21B - JR 21C - JX 21A -	50 00 599 360
	L 64.8M3	9 43 541 600
	PG 3064(4x4)	9 43 541 500
	PG 3066	9 43 541 600
	PGC191 -PGC 231	9 43 541 600
	PH 3L620 - PH 3L635 - PH 4 - PH 8 - PH 85 - PH 100 - PHL - PHL 8	9 43 541 600
	PHN10-PM4	9 43 541 600
	PM 5/2	9 43 541 600
	SM 10-SM 12-SM 170	77 01 200 237
	SM 21180	77 01 200 237
	TAK8	9 43 541 600
	TAK 160 - TAK 205A - TAK 205B - TAK 205C	9 43 541 600
	TB 191 - TB 231	9 43 541 600
	TBH 260 - TBH 280 (6x6)	9 43 541 600
	TB0 15M3 (6x4)	9 43 541 600
	TF 230 - TF 231 - TF 231 D	9 43 541 600
	TLM 15M3	9 43 541 600
	TP 170	9 43 541 600
	TR 255	9 43 541 600
	TRH 350 - TRH 350PC - TRH 350TS	9 43 541 600
SAVIEM		23232057 77 01 002 247

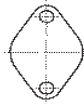
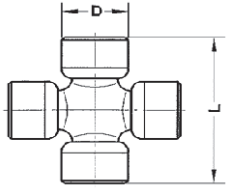

SM Ref.: 39400

Cross Ref.:

U400 5-16X
 18400 5-279-2X
 20104 5-279X
 20134
 5-116X



D 47,62	L 134,82	F -	R -	S -	T -	Lubricator 3
-------------------	--------------------	---------------	---------------	---------------	---------------	------------------------

APPLICATION

OE Ref.:

SCANIA		OE Ref.:
		78060
VOLVO		
Truck	N7 - TN7 FB86 - F86 - F87 - F88 - N86 - N88 - NB86 G89 (4x2) - G89 (6x4) - G89 (6x6)	46240 46240 46240 6621920

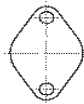
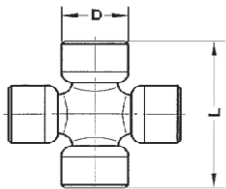

SM Ref.: 39429

Cross Ref.:

U429
 15192
 20347
 5-438X
 5-674X



D 47,62	L 134,82	F -	R -	S -	T -	Lubricator 3
-------------------	--------------------	---------------	---------------	---------------	---------------	------------------------

APPLICATION

OE Ref.:

APPLICATION		OE Ref.:

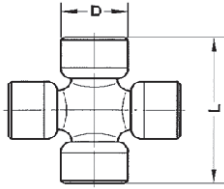

SM Ref.: 39767

Cross Ref.:

U767
14157



D	L	F	R	S	T	Lubricator
48,00	116,50	-	-	-	-	2

APPLICATION		OE Ref.:
DAF		
Truck	F2100-F2105 F2300 - 2305 (4x2) - FA/FT 2300 - FA/FT 2800 F2300 - 2305 (6x4) - FA/FT 2300 - FA/FT 2800 FA - FAS - FAT2200 - 2205DHB FA - FM - FT - FAR - FAS - FAT - 2000 - 2005 FAT - FTT2800 - 2805DKA - DKT - DKTD (6x4) FAT - FTT2800 - 2805DKS (6x4)	507539 507539 507539 507539 507539 507539 507539 609866
FIAT / IVECO		
Bus	470 - 570 - 670 470 - 570 - 670 470 - 570 - 670 470 - 570 - 670	93159304 2981719 93159311 93159313
Truck	120.25AN 120.25AN 190.20N - 190PAC20 - 190.26H - 190.30H - 190.35 H 190.20N - 190PAC20 - 190.26H - 190.30H - 190.35 H 190.26H - 190.26 HW - 190.26N - 190.30H - 190.35H 260.25AHW - 260.25AN - 260.26H - 260.26N - 260.26HW - 260.32AH - 260.32AHW 260.35H - 260.35HT - 260.35HW 330.25AN - 330.26H - 330.30H - 330.32AN - 330.35H - 330.35HT - 330.35HW 330.36AH - 330.36AHT 330.36AH - 330.36AHT	42484713 2981719 2980490 42484713 42484713 93159311 2980490 2981719 93159304 93159313 2981719 2980490
MAN		
Truck	14168F -14192 F, 14192 FK - 14192 FL -14192 FS 12240 FAEG 15168 F - 15168 FK -15168 FL - 15168 FS 16168 HA - 16168 HAK - 16192 HA	81.39200.6011 81.39200.6011 81.39200.6011 81.39200.6011
RVI		
Truck	HB 15 - HB 17 - HB 19 - HB 26 - HB 26T - HF 15 - HF 17 - HF 19T - HM 15-HM 17-HM 19-HM 26	50 00 588 218 50 00 588 218
SAVIEM		
Truck & Van		50 00 588 218
STEYR		
Various trucks		99000310708 99100310701

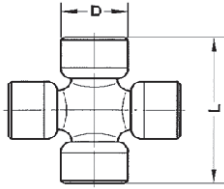

SM Ref.: 39765

Cross Ref.:

U765
13598



D	L	F	R	S	T	Lubricator
48,00	126,00	-	-	-	-	2

APPLICATION

OE Ref.:

FIAT / IVECO

Truck	190.26H-190.35H	42485180
	260.26H - 260.35H	42485180
	330.26H	42485180

MERCEDES - BENZ

Truck	303 (all models)	381 410 0231
	303 (all models)	385 410 0531
	305G.307/001/005/051/055	385 410 0531
	1017A-AF-AS-F-K-KO-LS	385 410 0531
	1217- 1219-1313- 1413-A-AF-L-LA-LAK	385 410 0531
	1417- 1418- 1419- 1420 A-AK-L-LF-F	385 410 0531
	1613-1613 K-1619 A-AK-K-KO-L-LPKO-S	381 410 0231
	1813- 1817-1819-1919 AK-K-S	385 410 0531
	1928 - 1929 - 1932 - 1933 A - AK - AS - K - LP - LPS - S	381 410 0231
	2024 - 2026 - 2032 - 2219 - LPS - S - LS - K - KO - L - LP - LPK	385 410 0531
	2220 - 2223 LP - 2224 B - K - LP - LPB - LPK - LPS - S	385 410 0531
	2448 - 2624 L - LAK - 2626 - 2628 A - AB - AK - AS	387 410 0131
	2629 - 2632 - 2635 - 2638 - A - AK - AS - S	387 410 0131
		360 410 0231

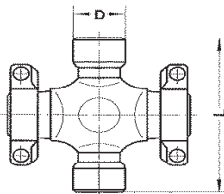

SM Ref.: 39948

Cross Ref.:

U948
U950
18244
10054



D	L	F	R	S	T	Lubricator
48,00	161,00	-	-	-	-	2

APPLICATION

OE Ref.:

SCANIA

Truck	LBT141 (last model)-T61	294383
	LBT141 (new model) - P40	337059
	P40, PF40	337059
	T61, TA61	
		365901

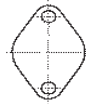
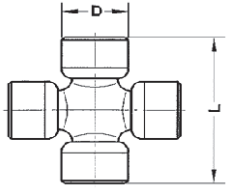

SM Ref.: 39958

Cross Ref.:

U958 5-281X
 13840
 20132
 20137
 5-281-4X



D 49,20	L 191,72	F -	R -	S -	T -	Lubricator 3
-------------------	--------------------	---------------	---------------	---------------	---------------	------------------------

APPLICATION

OE Ref.:

SEDDON ATKINSON

301 Series
 401 Series

--	--	--	--	--	--	--

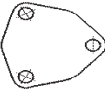
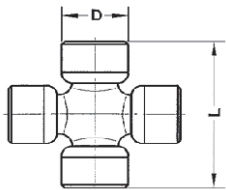

SM Ref.: 39381

Cross Ref.:

U381
 10076



D 50,00	L 152,60	F -	R -	S -	T -	Lubricator 2
-------------------	--------------------	---------------	---------------	---------------	---------------	------------------------

APPLICATION

OE Ref.:

SCANIA

Truck

L 76 - LB 76—LS 76 - L 66 - L 75 - LS 75

550613

VOLVO

1651032
 231519
 232459

--	--	--	--	--	--	--

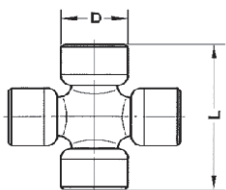

SM Ref.: 39388

Cross Ref.:

U388
 10061



D 50,00	L 164,00	F -	R -	S -	T -	Lubricator 3
-------------------	--------------------	---------------	---------------	---------------	---------------	------------------------

APPLICATION

OE Ref.:

SCANIA

Truck

L - LB 140 - 141 P (4x2) L - BS 140 (6x2)
 LS - 140 (6x4) LT 110 - 111 P - 145 - 146 (6x4)
 T70, TA70

264044
 207563

--	--	--	--	--	--	--

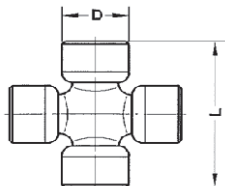

SM Ref.: 39756

Cross Ref.:

U756
12840



D	L	F	R	S	T	Lubricator
52,00	133,00	-	-	-	-	2

APPLICATION

OE Ref.:

DAF		
Truck	F2300 - 2305 (4x2) - A1900DS - FA/FT2300 - FA/FT2800 F2300 - 2305 (6x4) - AI 900 DS - FA/FT 2300 - FA/FT 2800 FA - FT - FAS - FTS2800 - 2805DKA - DKT - DKTD FAT - FTT2800 - 2805DKA - DKT - DKTD (6x4)	264354 264354 264354 264354
FIAT / IVECO		
Truck	180.24- 180.24T- 180.26 190.25AH - 190.25AHT - 190.25AHW - 190.25AN - 1 90.20AHW - 190.32AH- 190.35H 260.25AH - 260.25AHW - 260.26H - 260.26HW - 260.26N - 260.32AH - 260.32AHW -260.35H - 260.35HT - 260.35HW 330.25AN - 330.26H - 330.30H - 330.32AN - 330.35H - 330.35HT - 330.35AH - 330.36AHT 330.35HW	2969532 8198583 2984515 8198583 2969532 8198583 42493397 2984515
MAN		
Bus	SD200 SG 192 SL200	81.39200.6016 81.39200.6016 81.39200.6016
Truck	SUE 240 - SR 240 12240 FAEG 12240 FAEG 15200 F - 15200 FK - 15200 FL - 15200 FLS - 15200 FS - 15200 H - 15200 HK- 15200 HS 15200 HA - 15200 HAK - 15200 HAS 15240 F - 15240 FK -15240 FL - 15240 FLS - 15240 FS - 15240 H - 15240 HA - 15240 HAK - 15240 HAS 16200 F - 16200 FK - 16200 HA - 16200 H - 16200 HK - 16200 HAK 16240 F - 16240 FK - 16240 FA - 16240 HK - 16240 HR 16240 FA - 16240 HA - 16240 HAK - 16240 OEAF - 16241 U 16256 F - 16256 FK - 16256 FL - 16256 FLS - 16256 FS 16256 H - 16256 HK - 16256 HL - 16256 HS 16256 HA - 16256 HAK - 16256 HAS 19200 F-19200 H- 19200 HA 19232 F - 19232 H- 19232 HA 19240 F - 19240 FK - 19240 FS - 19240 H - 19240 HK - 19240 HS 19240 HA - 19240 HAK - 19240 HAS 19241 U - 19256 F - 19256 FLS - 19256 FS - 19256 H - 19256 HK - 20280 DFAEG (4x4) 22200 FNL 22240 DH - 22240 DHK 22240 NL - 22240 FNL 26232 DHA 26240 DF - 26240 DFK - 26240 DFS - 26240 DFTM - 26240 DH - 26240 DFA (6x6) 26240 DHA 26281 DF (6x4) - 26281 DH 26281 DFA-26281 DHA(6x6) 26320 DF - 26320 DFK - 26320 DFL - 26320 DFLS - 26320 DH - 26320 DFA - 26320 DFAK - 26320 DFAS - 26320 DHA - 26320 DHAH - 26321 DFA - 26321 DHA 30240 DF - 30240 DFK - 30240 DFS - 30240 DFTM - 30240 DH - 30281 VF	81.39200.6016 81.39200.6016 81.39200.6016 81.39200.6016 81.39200.6010 81.39200.6016 81.39200.6010 81.39200.6016

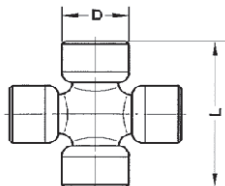

SM Ref.: 39756

Cross Ref.:

U756
12840



D	L	F	R	S	T	Lubricator
52,00	133,00	-	-	-	-	2

APPLICATION

OE Ref.:

MAN

Truck

30320 DF - 30320 DFK - 30320 DFS - 30321 VF	81.39200.6016
32281 DFA	81.39200.6016
32281 DH	81.39200.6016
32240 DFA (6x6)	81.39200.6016
32240 DHA	81.39200.6016
32320 DFAK - 32320 DFAS	81.39200.6016
40365 DF - 40400 DF - 40400 OEAF	81.39200.6016
40365 A - 40400 DSA - 40400 OEAS - 40440 A	81.39200.6016

MERCEDES - BENZ

Truck

303.600/109/110/111	335 410 0031
1117 K - L - 1120 AF-1120L	335 410 0031
1424 F - K - LP - LS - LPS - S	335 410 0031
1620- 1620 L	335 410 0031
1621-1624L- LK- LAK- LS- LAS - LPK- LS - LPS	335 410 0031
1921-1924-1926 L- LK- LS - LAK- LAS - LK- LS	335 410 0031
1928 - 1929 - 1932 - 1933 A - AK - AS - K - LP - LPS - S	335 410 0031
1935 - 1936 - 1938 - 1944 - AS - AK - LAS - LS	335 410 0031
2024 - 2026 - 2032 - 2219 - LPS - S - LS - K - KO - L - LP - LPK	335 410 0031
2220 - 2223 LP - 2224 B - K - LP - LPB - LPK - LPS - S	335 410 0031
2226 - 2228 - 2232 - 2233 L - LP - LPB - LPK - LS	335 410 0031
2629 - 2632 - 2635 - 2638 - A - AK - AS - S	335 410 0031
2719 C / 2200 - 619011/012/014	335 410 0031
3236 A - 3236 A (6x6)	335 410 0031
3250 AF - 3250 A (6x6) - 3250 A - AF - 3535 K	335 410 0031
4850 A (8x8) / 625057	335 410 0031
	385 410 0531

NEOPLAN

Couch

RVI

Truck

GBH 260 - GBH 280 (6x6)	50 00 242 009
PR 360	50 00 242 009
PS 30 - PS 30T	3397100
R 360 (6x4)	50 00 242 009
R 360PR (6x4)	50 00 242 009
R 360TR (6x4)	50 00 242 009
TBH 260 - TBH 280 (6x6)	50 00 242 009
TR 251	50 00 242 009

SAVIEM

Truck & Van

50 00 242 009

STEYR

Various trucks

99014310703

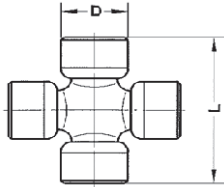

SM Ref.: 39909

Cross Ref.:

U909
17033



D	L	F	R	S	T	Lubricator
52,00	147,20	-	-	-	-	2

APPLICATION

OE Ref.:

DAF

Truck

F75 (6x4, 8x4) , 38-40t
FAT75, ZF9S109, ZF16S109
F85 (4x2, 6x2), 44-50t
F95 (4x2, 6x2), 50-52t, Engine WS268 1500
FAS95 lowdeck, Engine WS268
FTR95, Engine WS268
FAR95, Engine WS268
FAR95, Engine WS295, TS 126012
FA85, FT85, FAS85, FTG85, FAG85, FAR85

FIAT / IVECO

Eurocargo

179E24- 179E27- 179E30
390E34
Eurocargo

93163090
93163090
93163090

MAGIRUS / IVECO

Truck

MT180E30-E34 (4x2)
MT190E24-E27-E30(4x2)
MT 400 E 30 - E 34 (4x2)

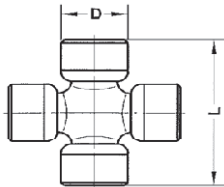

SM Ref.: 39761

Cross Ref.:

U993
U761



D	L	F	R	S	T	Lubricator
53,00	135,05	-	-	-	-	2

APPLICATION

OE Ref.:

MERCEDES - BENZ

Truck

1424 F - K - LP - LS - LPS - S
1621-1624L- LK-LAK- LS- LAS- LPK-LS- LPS
1921-1924-1926 L- LK- LS - LAK- LAS - LK- LS
1928- 1929- 1932- 1933 A - AK - AS - K - LP - LPS - S
2024 - 2026 - 2032 - 2219 - LPS - S - LS - K - KO - L - LP - LPK
2220 - 2223 LP - 2224 B - K - LP - LPB - LPK - LPS - S
2226 - 2228 - 2232 - 2233 L - LP - LPB - LPK - LS
2235 K - LS - 2238 - 2429 K - LS - 2435 L - LS
2448 - 2624 L - LAK - 2626 - 2628 A - AB - AK - AS
2629 - 2632 - 2635 - 2638 - A - AK - AS - S
3236 A - 3236 A (6x6)
3250 AF - 3250 A (6x6) - 3250 A - AF - 3535 K
4050 A (8x8) / 625052-54
4850 A (8x8) / 625057

363 410 0631
363 410 0631
363 410 0631
363 410 0631
363 410 0631
363 410 0631
363 410 0631
363 410 0631
363 410 0631
363 410 0631
363 410 0361
363 410 0361
363 410 0361
363 410 0361
363 410 0361

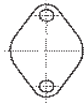
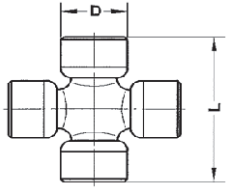

SM Ref.: 39170

Cross Ref.:

SPL170X



D	L	F	R	S	T	Lubricator
55,00	163,90	-	-	-	-	-

APPLICATION

OE Ref.:

VOLVO		OE Ref.:
		3947697

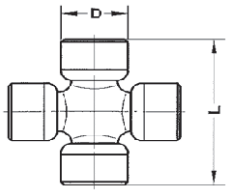

SM Ref.: 39813

Cross Ref.:

U813

13070



D	L	F	R	S	T	Lubricator
57,00	144,00	-	-	-	-	2

APPLICATION

OE Ref.:

DAF		OE Ref.:
Truck	FA - FT - FAS - FTS - 2800 - 2805DKS	505698
	FAT - FTT2800 - 2805DKS (6x4)	505698
FIAT / IVECO		OE Ref.:
Truck	190.25AHW - 190.25AN - 190.26HW - 190.26N - 190.30H	2980217
	190.25AHW - 190.25AN - 190.26HW - 190.26N - 190.30H	93190028
	260.25AH - 260.25AHW - 260.25AN - 260.26N - 260.26HW -	93190028
	260.32AH - 260.32AHW	42481507
	260.32AH - 260.32AHW - 260.35HW	42491973
	330.25AN - 330.26H - 330.26N - 330.30H - 330.32AN - 330.35H -	93190028
	330.35HT - 330.35HW	42481507
MAGIRUS / IVECO		OE Ref.:
Truck	310 D22AK - D16K - D22FS (6x4)	2980217
MAN		OE Ref.:
Truck	16280 F- 16281 F- 16281 FL - 16281 H	81.39200.6015
	16281 FA - 16281 HA (4x4)	81.39200.6015
	16320 F - 16320 FK - 16320 FL - 16320 FS - 16320 H - 16320 HK -	81.39200.6015
	16321 U- 16321 UL	81.39200.6015
	19215DFA(6x6)-16215DHKA-19215DHSA	81.39200.6015
	19280 F- 19281 FL- 19281 H	81.39200.6015
	19304 DFA (6x6) - 19304 DFK	81.39200.6015
	19320 F - 19320 FK - 19320 FL - 19320 FLS - 19320 H - 19320 HK -	81.39200.6015
	19321 F - 19321 FL - 19390 F - 19321 U - 19321 UL	81.39200.6015
	20281 FVLS - 20230 FVLS	81.39200.6015
	22240 NL - 22240 FNL	81.39200.6015
	22241 UNL-22281 FNL	81.39200.6015
	22320 FNL - 22320 UNL - 22321 FNL	81.39200.6015
	22321 UNL	81.39200.6015
	26240 DFA (6x6)	81.39200.6015
	26320 DF - 26320 DFK - 26320 DFL - 26320 DFSL - 26320 DH -	81.39200.6015
	26320 DFA - 26320 DFAK - 26320 DFAS - 26320 DHA - 26320 DHAK -	81.39200.6015

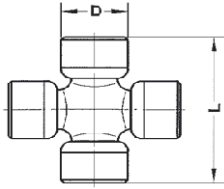

SM Ref.: 39813

Cross Ref.:

U813
13070



D	L	F	R	S	T	Lubricator
57,00	144,00	-	-	-	-	2

APPLICATION

OE Ref.:

MAN		
Truck	30281 VF	81.39200.6015
	30320 DF - 30320 DFK - 30320 DFS - 30321 VF	81.39200.6015
	32240 DFA (6x6)	81.39200.6015
	32320 DFAK - 32320 DFAS	81.39200.6015
RVI		
Truck	GBH 260 - GBH 280 (6x6)	50 00 280 190
	GBH 260 - GBH 280 (6x6)	50 00 559 743
	GLM15M2	50 00 280 190
	GLM15M2	50 00 559 743
	GR 305	50 00 280 190
	GR 305	50 00 559 743
	GR 311	50 00 280 190
	GR 311	50 00 559 743
	PR 350 - PR 350T	50 00 280 190
	PR 350 - PR 350T	50 00 559 743
	PX30	50 00 280 190
	PX30	50 00 559 743
	R310-R310T-R360-R360T	50 00 280 190
	R310-R310T-R360-R360T	50 00 559 743
	R 360 (6x4)	50 00 280 190
	R 360 (6x4)	50 00 559 743
	R 360PR (6x4)	50 00 280 190
	R 360PR (6x4)	50 00 559 743
	R 360TR (6x4)	50 00 280 190
	R 360TR (6x4)	50 00 559 743
	R 370 - R 370T	50 00 280 190
	R 370 - R 370T	50 00 559 743
	TBH 260 - TBH 280 (6x6)	50 00 280 190
	TBH 260 - TBH 280 (6x6)	50 00 559 743
	TR 305 TR 310	50 00 280 190
	TR 305 TR 310	50 00 559 743
	TR 311	50 00 280 190
	TR 311	50 00 559 743
STEYR		
Various trucks		99014310722

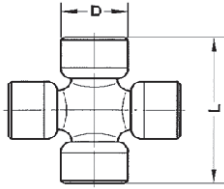

SM Ref.: 39763

Cross Ref.:

U763
13140



D 57,00	L 152,00	F -	R -	S -	T -	Lubricator 2
-------------------	--------------------	---------------	---------------	---------------	---------------	------------------------

APPLICATION

OE Ref.:

MAN		OE Ref.:
Truck	12240 FAEG 16281 FA- 16281 HA (4x4) 26281 DF (6x4) - 26281 DH 26281 DFA - 26281 DHA (6x6) 26321 DFA - 26321 DHA 32281 DFA 32281 DH 40365 DF - 40400 DF - 40400 OEAF 40365 A - 40400 DSA - 40400 OEAS - 40440 A	
MERCEDES - BENZ		OE Ref.:
Truck	1928- 1929 - 1932 - 1933 A - AK - AS - K - LP - LPS - S 1928 - 1929 - 1932 - 1933 A - AK - AS - K - LP - LPS - S 2024 - 2026 - 2032 - 2219 - LPS - S - LS - K - KO - L - LP - LPK 2226 - 2228 - 2232 - 2233 L - LP - LPB - LPK - LS 2235 K - LS - 2238 - 2429 K - LS - 2435 L - LS 2448 - 2624 L - LA - LAK - 2626 - 2628 A - AB - AK - AS 2629 - 2632 - 2635 - 2638 - A - AK - AS - S 3235/625121 3250 AF - 3250 A (6x6) - 3250 A - AF - 3535 K	387 410 0031 620 410 0031 387 410 0031 387 410 0031 620 410 0031 620 410 0031 620 410 0031 620 410 0031 387 410 0031 387 410 0031

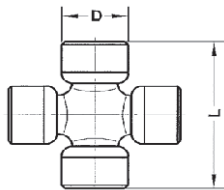

SM Ref.: 39990

Cross Ref.:

U990
16139



D 57,00	L 152,00	F -	R -	S -	T -	Lubricator 2
-------------------	--------------------	---------------	---------------	---------------	---------------	------------------------

APPLICATION

OE Ref.:

VOLVO		OE Ref.:
Truck	F10-FL10-N10-N12-F12	1651229

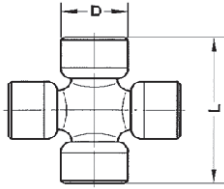

SM Ref.: 39949

Cross Ref.:

U949
14974



D	L	F	R	S	T	Lubricator
57,00	164,00	-	-	-	-	2

APPLICATION

OE Ref.:

SCANIA

P 50
T

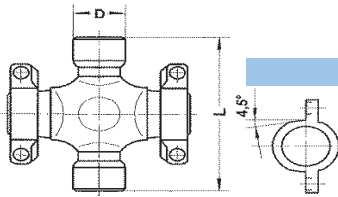

SM Ref.: 39954

Cross Ref.:

U954
10056



D	L	F	R	S	T	Lubricator
57,00	164,00	-	-	-	-	2

APPLICATION

OE Ref.:

SCANIA

Truck

LB141 (last model) - T71
LB141 (new model) -
P50, PF50
T71, TA71, T81, TA81

294385
337060
390225

366437
366441
366443

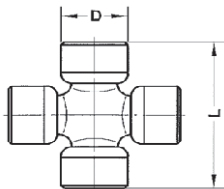

SM Ref.: 39918

Cross Ref.:

U918



D	L	F	R	S	T	Lubricator
59,00	167,40	-	-	-	-	2

APPLICATION

OE Ref.:

FIAT / IVECO

Bus
Truck

421A-421AL
160.26 - 160.26T
170.26 - 170NC26 - 170NT26 - 170NT33 - 170NC26 - 170NT33 -
180NC
180NT-180NTS
256.M16 - 256.M19 - 256.M22
300PC - 300PT
320.M16 - 320.M19 - 320.M22
619N1 - 619N1P - 619T1 - 619T1P
682T3 - 682T4
691N - 691T
697N

7981059
7981059
7981059
7981059
7981059
7981059
7981059
7981059
7981059
7981059
7981059
7981059

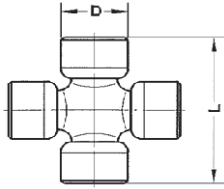

SM Ref.: 39250

Cross Ref.:

250X



D	L	F	R	S	T	Lubricator
60,00	163,00	-	-	-	-	-

APPLICATION

OE Ref.:

VOLVO		OE Ref.:
		3947698

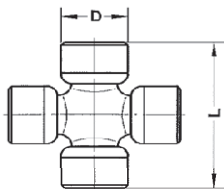

SM Ref.: 39982

Cross Ref.:

U982

14186



D	L	F	R	S	T	Lubricator
65,00	172,00	-	-	-	-	2

APPLICATION

OE Ref.:

DAF		OE Ref.:
Truck	F95 (6x4, 8x4), 52-56t, Engine WS315 1765 FAT95 - FTT95 - FAD95, Engine WS315	
FIAT / IVECO		OE Ref.:
Truck	190.30 Turbo Star - 190.33 - 190.36 - 190.38 - 190.42 - 190.48 - 190.48P - 190.48T - 190.48PT Turbo Star 240.48 260.48 330.36AH - 330.36AHT	8194583 93156581 93156581 93156581 42490052
MERCEDES - BENZ		OE Ref.:
Truck	26485/659196 3236 A (6x6)	645 410 0131 645 410 0131

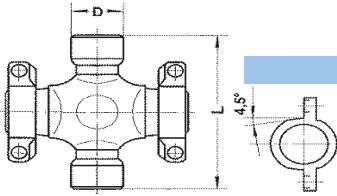

SM Ref.: 39924

Cross Ref.:

U924
18687



D 65,00	L 190,00	F -	R -	S -	T -	Lubricator 2
-------------------	--------------------	---------------	---------------	---------------	---------------	------------------------

APPLICATION

OE Ref.:

SCANIA						
Truck	P60, PF60					386073

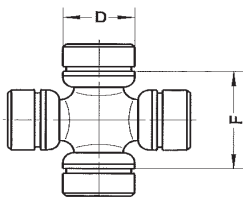

SM Ref.: 39462

Cross Ref.:

U462
18154



D 68,00	L -	F 89,00	R -	S -	T -	Lubricator 2
-------------------	---------------	-------------------	---------------	---------------	---------------	------------------------

APPLICATION

OE Ref.:

MERCEDES - BENZ						
						656 410 0131

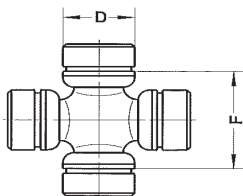

SM Ref.: 39993

Cross Ref.:

U996



D 68,00	L -	F 117,00	R -	S -	T -	Lubricator 1
-------------------	---------------	--------------------	---------------	---------------	---------------	------------------------

APPLICATION

OE Ref.:

MERCEDES - BENZ						
						942 410 0231

**Vergleichsnummern Liste
KREUZGELENKE**

**Cross reference list
UNIVERSAL JOINTS**

**Liste d'équivalences
JOINT DE CARDAN**

**Lista de intercambios
CRUZETA DE CARDAN**

**VERGLEICHSNUMMERN
CROSS-REFERENCES
GKN - SM**

GKN cross-ref.	SM ref.:	Product Cat.	Manufacturer Type	Measurement D
U100	39100	Universal Joint	Alfa, Buick, Jeep, Mitsubishi,Rover, VW, Volvo	26,97 mm
U110	39110	Universal Joint	Berliet, Ferrari, Fiat, Renault,Rover, VW, Volvo	26,97 mm
U178	39178	Universal Joint	VW	27,00 mm
U220	39220	Universal Joint	Dodge, Ferrari, Maserati, Pontiac	30,15 mm
U325	39325	Universal Joint	Mercedes Benz	31,00 mm
U350	39350	Universal Joint	Alfa, DAF, Fiat, Ford, RVI,Scania, Volvo	39,63 mm
U380	39380	Universal Joint	Volvo	44,00 mm
U381	39381	Universal Joint	Scania	50,00 mm
U384	39384	Universal Joint	Scania	44,00 mm
U388	39388	Universal Joint	Scania	50,00 mm
U400	39400	Universal Joint	Alfa, Fiat, Ford, RVI, Saviem,Volvo	47,62 mm
U429	39429	Universal Joint		47,62 mm
U462	39462	Universal Joint	Mercedes Benz	68,00 mm
U728/4	397284	Universal Joint	Mercedes Benz	24,06 mm
U730	39730	Universal Joint	Mercedes Benz	38,00 mm
U743	39743	Universal Joint	DAF, Steyr	35,00 mm
U747	39747	Universal Joint	Mercedes Benz	42,00 mm
U753	39753	Universal Joint	Mercedes Benz	45,00 mm
U932	39753	Universal Joint	Mercedes Benz	45,00 mm
U756	39756	Universal Joint	DAF, Mercedes Benz, Fiat,RVI, Steyr	52,00 mm
U761	39761	Universal Joint	Mercedes Benz	53,00 mm
U 993	39761	Universal Joint	Mercedes Benz	53,00 mm
U763	39763	Universal Joint	MAN, Mercedes Benz	57,00 mm
U765	39765	Universal Joint	Fiat, Mercedes Benz	48,00 mm
U767	39767	Universal Joint	DAF, Fiat, MAN, RVI, Steyr	48,00 mm
U813	39813	Universal Joint	DAF, Fiat, Deutz, MAN, RVI,Steyr	57,00 mm
U909	39909	Universal Joint	DAF, Fiat, MAN	52,00 mm
U918	39918	Universal Joint	Fiat Iveco	59,00 mm
U924	39924	Universal Joint	Scania	65,00 mm
U948	39948	Universal Joint	Scania	48,00 mm
U950	39948	Universal Joint	Scania	48,00 mm
U949	39949	Universal Joint	Scania	57,00 mm
U954	39954	Universal Joint	Scania	57,00 mm
U958	39958	Universal Joint	Seddon Atkinson	49,20 mm
U982	39982	Universal Joint	DAF, Fiat, Mercedes Benz	65,00 mm
U990	39990	Universal Joint	Volvo	57,00 mm
U996	39993	Universal Joint	Mercedes Benz	68,00 mm

**VERGLEICHNUMMERN
CROSS-REFERENCES
OEM - SM**

OEM cross-ref.	SM ref.:	Product Cat.	Manufacturer Type	Measurement D
9813973	39110	Universal Joint	Alfa Romeo	26,97 mm
01735-25704	39350	Universal Joint	Alfa Romeo	39,63 mm
01735-25704	39400	Universal Joint	Alfa Romeo	47,62 mm
7190326	39110	Universal Joint	Bedford	26,97 mm
8845370	39100	Universal Joint	Bedford	26,97 mm
7088368	39350	Universal Joint	Bedford	39,63 mm
7088370	39350	Universal Joint	Bedford	39,63 mm
7178684	39350	Universal Joint	Bedford	39,63 mm
91021384	39350	Universal Joint	Bedford	39,63 mm
7206809	39400	Universal Joint	Bedford	47,62 mm
943541019	39110	Universal Joint	Berliet	26,97 mm
3400021	39350	Universal Joint	Berliet	39,63 mm
3400040	39350	Universal Joint	Berliet	39,63 mm
943541500	39350	Universal Joint	Berliet	39,63 mm
943541600	39400	Universal Joint	Berliet	47,62 mm
110310120	39110	Universal Joint	Citroen	26,97 mm
603710810	39350	Universal Joint	Citroen	39,63 mm
542635	39743	Universal Joint	DAF	35,00 mm
316340	39350	Universal Joint	DAF	39,63 mm
507539	39767	Universal Joint	DAF	48,00 mm
609866	39767	Universal Joint	DAF	48,00 mm
264354	39756	Universal Joint	DAF	52,00 mm
505698	39813	Universal Joint	DAF	57,00 mm
693864	39220	Universal Joint	Dennis	30,15 mm
686704	39350	Universal Joint	Dennis	39,63 mm
1305151	39400	Universal Joint	Dennis	47,62 mm
4552008	39110	Universal Joint	Fiat	26,97 mm
4556519	39110	Universal Joint	Fiat	26,97 mm
876045	39110	Universal Joint	Fiat	26,97 mm
882320	39110	Universal Joint	Fiat	26,97 mm
883236	39110	Universal Joint	Fiat	26,97 mm
967265	39110	Universal Joint	Fiat	26,97 mm
105E-7039	39110	Universal Joint	Ford	26,97 mm
213E-4635A	39110	Universal Joint	Ford	26,97 mm
2400E-4635A	39110	Universal Joint	Ford	26,97 mm
3010E-4635A	39110	Universal Joint	Ford	26,97 mm
404E-4635A	39110	Universal Joint	Ford	26,97 mm
EDA-7039	39110	Universal Joint	Ford	26,97 mm
01T-7039	39220	Universal Joint	Ford	30,15 mm
568E-7039	39350	Universal Joint	Ford	39,63 mm
2002E4635A	39400	Universal Joint	Ford	47,62 mm
04679120	39350	Universal Joint	Iveco	39,63 mm
05985281	39350	Universal Joint	Iveco	39,63 mm
09932700	39350	Universal Joint	Iveco	39,63 mm
4641105	39350	Universal Joint	Iveco	39,63 mm
4679190	39350	Universal Joint	Iveco	39,63 mm
4679796	39350	Universal Joint	Iveco	39,63 mm
5952651	39350	Universal Joint	Iveco	39,63 mm
7981058	39350	Universal Joint	Iveco	39,63 mm
8120185	39350	Universal Joint	Iveco	39,63 mm
9105823	39350	Universal Joint	Iveco	39,63 mm
9932700	39350	Universal Joint	Iveco	39,63 mm
4656653	39400	Universal Joint	Iveco	47,62 mm
4686738	39400	Universal Joint	Iveco	47,62 mm
4699481	39400	Universal Joint	Iveco	47,62 mm
8190503	39400	Universal Joint	Iveco	47,62 mm
9981618	39400	Universal Joint	Iveco	47,62 mm

**VERGLEICHSNUMMERN
CROSS-REFERENCES
OEM - SM**

OEM cross-ref.	SM ref.:	Product Cat.	Manufacturer Type	Measurement D
9982407	39400	Universal Joint	Iveco	47,62 mm
2980490	39767	Universal Joint	Iveco	48,00 mm
2981719	39767	Universal Joint	Iveco	48,00 mm
42484713	39767	Universal Joint	Iveco	48,00 mm
93159304	39767	Universal Joint	Iveco	48,00 mm
93159311	39767	Universal Joint	Iveco	48,00 mm
93159313	39767	Universal Joint	Iveco	48,00 mm
42485180	39765	Universal Joint	Iveco	48,00 mm
2969532	39756	Universal Joint	Iveco	52,00 mm
2984515	39756	Universal Joint	Iveco	52,00 mm
42493397	39756	Universal Joint	Iveco	52,00 mm
8198583	39756	Universal Joint	Iveco	52,00 mm
93163090	39909	Universal Joint	Iveco	52,00 mm
2980217	39813	Universal Joint	Iveco	57,00 mm
42481507	39813	Universal Joint	Iveco	57,00 mm
42491973	39813	Universal Joint	Iveco	57,00 mm
93190028	39813	Universal Joint	Iveco	57,00 mm
7981059	39918	Universal Joint	Iveco	59,00 mm
42490052	39982	Universal Joint	Iveco	65,00 mm
8194583	39982	Universal Joint	Iveco	65,00 mm
93156581	39982	Universal Joint	Iveco	65,00 mm
2980217	39813	Universal Joint	KHD	57,00 mm
201SJ-22	39100	Universal Joint	MACK	26,97 mm
201SJ-11	39220	Universal Joint	MACK	30,15 mm
201SJ-26	39220	Universal Joint	MACK	30,15 mm
201SJ-14	39400	Universal Joint	MACK	47,62 mm
201SJ-25	39400	Universal Joint	MACK	47,62 mm
2104-5279X	39400	Universal Joint	MACK	47,62 mm
81.39200.6011	39767	Universal Joint	MAN	48,00 mm
81.39200.6016	39756	Universal Joint	MAN	52,00 mm
81.39200.6015	39813	Universal Joint	MAN	57,00 mm
6014100231	397284	Universal Joint	Mercedes-Benz	24,06 mm
0304100431	39743	Universal Joint	Mercedes-Benz	35,00 mm
0304101831	39743	Universal Joint	Mercedes-Benz	35,00 mm
3024100031	39730	Universal Joint	Mercedes-Benz	38,00 mm
3104100031	39730	Universal Joint	Mercedes-Benz	38,00 mm
3124111231	39730	Universal Joint	Mercedes-Benz	38,00 mm
3124111331	39730	Universal Joint	Mercedes-Benz	38,00 mm
3224110031	39730	Universal Joint	Mercedes-Benz	38,00 mm
3224110131	39730	Universal Joint	Mercedes-Benz	38,00 mm
3854100231	39730	Universal Joint	Mercedes-Benz	38,00 mm
3174100131	39747	Universal Joint	Mercedes-Benz	42,00 mm
3374100031	39747	Universal Joint	Mercedes-Benz	42,00 mm
3374100531	39747	Universal Joint	Mercedes-Benz	42,00 mm
3544100131	39747	Universal Joint	Mercedes-Benz	42,00 mm
3854100131	39747	Universal Joint	Mercedes-Benz	42,00 mm
3044100031	39753	Universal Joint	Mercedes-Benz	45,00 mm
3174100031	39753	Universal Joint	Mercedes-Benz	45,00 mm
3604100231	39765	Universal Joint	Mercedes-Benz	48,00 mm
3814100231	39765	Universal Joint	Mercedes-Benz	48,00 mm
3854100531	39765	Universal Joint	Mercedes-Benz	48,00 mm
3874100131	39765	Universal Joint	Mercedes-Benz	48,00 mm
3354100031	39756	Universal Joint	Mercedes-Benz	52,00 mm
3634100631	39761	Universal Joint	Mercedes-Benz	53,00 mm
3874100031	39763	Universal Joint	Mercedes-Benz	57,00 mm
6204100031	39763	Universal Joint	Mercedes-Benz	57,00 mm
6454100131	39982	Universal Joint	Mercedes-Benz	65,00 mm

**VERGLEICHNUMMERN
CROSS-REFERENCES
OEM - SM**

OEM cross-ref.	SM ref.:	Product Cat.	Manufacturer Type	Measurement D
9424100231	39993	Universal Joint	Mercedes-Benz	68,00 mm
6564100131	39462	Universal Joint	Mercedes-Benz	68,00 mm
9424100031	39462	Universal Joint	Mercedes-Benz	68,00 mm
J-906926/9	39100	Universal Joint	Mitsubishi	26,97 mm
JA-7042	39100	Universal Joint	Mitsubishi	26,97 mm
K5-21X	39100	Universal Joint	Mitsubishi	26,97 mm
MJ-906929	39100	Universal Joint	Mitsubishi	26,97 mm
5000242492	39350	Universal Joint	R.V.I	39,63 mm
943541500	39350	Universal Joint	R.V.I	39,63 mm
5000559360	39400	Universal Joint	R.V.I	47,62 mm
7701200237	39400	Universal Joint	R.V.I	47,62 mm
943541600	39400	Universal Joint	R.V.I	47,62 mm
943541999	39400	Universal Joint	R.V.I	47,62 mm
5000588218	39767	Universal Joint	R.V.I	48,00 mm
3397100	39756	Universal Joint	R.V.I	52,00 mm
5000242009	39756	Universal Joint	R.V.I	52,00 mm
5000280190	39813	Universal Joint	R.V.I	57,00 mm
5000559743	39813	Universal Joint	R.V.I	57,00 mm
5000243236	39110	Universal Joint	Renault	26,97 mm
943541019	39110	Universal Joint	Renault	26,97 mm
242521	39110	Universal Joint	Rover	26,97 mm
243023	39110	Universal Joint	Rover	26,97 mm
243203	39110	Universal Joint	Rover	26,97 mm
512544	39110	Universal Joint	Rover	26,97 mm
541858	39110	Universal Joint	Rover	26,97 mm
504439	39100	Universal Joint	Rover	26,97 mm
515723	39100	Universal Joint	Rover	26,97 mm
542544	39100	Universal Joint	Rover	26,97 mm
601557	39100	Universal Joint	Rover	26,97 mm
23232051	39110	Universal Joint	Saviem	26,97 mm
5000243236	39110	Universal Joint	Saviem	26,97 mm
981397300	39110	Universal Joint	Saviem	26,97 mm
5000242492	39350	Universal Joint	Saviem	39,63 mm
7701005432	39350	Universal Joint	Saviem	39,63 mm
870550300	39350	Universal Joint	Saviem	39,63 mm
23232057	39400	Universal Joint	Saviem	47,62 mm
7701002247	39400	Universal Joint	Saviem	47,62 mm
5000588218	39767	Universal Joint	Saviem	48,00 mm
5000242009	39756	Universal Joint	Saviem	52,00 mm
47804	39350	Universal Joint	Scania	39,63 mm
750610	39350	Universal Joint	Scania	39,63 mm
77187	39350	Universal Joint	Scania	39,63 mm
178258	39384	Universal Joint	Scania	44,00 mm
264043	39384	Universal Joint	Scania	44,00 mm
297563	39384	Universal Joint	Scania	44,00 mm
550612	39384	Universal Joint	Scania	44,00 mm
750612	39384	Universal Joint	Scania	44,00 mm
78060	39400	Universal Joint	Scania	47,62 mm
294383	39948	Universal Joint	Scania	48,00 mm
337059	39948	Universal Joint	Scania	48,00 mm
365901	39948	Universal Joint	Scania	48,00 mm
550613	39381	Universal Joint	Scania	50,00 mm
207563	39388	Universal Joint	Scania	50,00 mm
264044	39388	Universal Joint	Scania	50,00 mm
294385	39954	Universal Joint	Scania	57,00 mm
337060	39954	Universal Joint	Scania	57,00 mm
366437	39954	Universal Joint	Scania	57,00 mm

**VERGLEICHNUMMERN
CROSS-REFERENCES
OEM - SM**

OEM cross-ref.	SM ref.:	Product Cat.	Manufacturer Type	Measurement D
366441	39954	Universal Joint	Scania	57,00 mm
366443	39954	Universal Joint	Scania	57,00 mm
390225	39954	Universal Joint	Scania	57,00 mm
386073	39924	Universal Joint	Scania	65,00 mm
292420713	39743	Universal Joint	Steyr	35,00 mm
99000310708	39767	Universal Joint	Steyr	48,00 mm
99100310701	39767	Universal Joint	Steyr	48,00 mm
99014310703	39756	Universal Joint	Steyr	52,00 mm
99014310722	39813	Universal Joint	Steyr	57,00 mm
3947698	39250	Universal Joint	Volvo	60,00 mm
383472	39110	Universal Joint	Volvo	26,97 mm
38403	39110	Universal Joint	Volvo	26,97 mm
36590	39350	Universal Joint	Volvo	39,63 mm
6621656	39350	Universal Joint	Volvo	39,63 mm
6852612	39350	Universal Joint	Volvo	39,63 mm
6876177	39350	Universal Joint	Volvo	39,63 mm
83453	39350	Universal Joint	Volvo	39,63 mm
231626	39380	Universal Joint	Volvo	44,00 mm
232458	39380	Universal Joint	Volvo	44,00 mm
7231265	39380	Universal Joint	Volvo	44,00 mm
46240	39400	Universal Joint	Volvo	47,62 mm
6621920	39400	Universal Joint	Volvo	47,62 mm
1651032	39381	Universal Joint	Volvo	50,00 mm
231519	39381	Universal Joint	Volvo	50,00 mm
232459	39381	Universal Joint	Volvo	50,00 mm
3947697	39170	Universal Joint	Volvo	55,02 mm
1651229	39990	Universal Joint	Volvo	57,00 mm

**VERGLEICHSDNUMMERN
CROSS-REFERENCES
SPICER - SM**

Spicer cross-ref.	SM ref.:	Product Cat.	Manufacturer Type	Measurement D
090X	39090	Universal Joint	Mercedes Benz	41,28 mm
170X	39170	Universal Joint	Volvo	55,02 mm
250X	39250	Universal Joint	Volvo	60,00 mm
5-113X	39100	Universal Joint	Alfa, Buick, Jeep, Mutsubishi,Rover, VW, Volvo	26,97 mm
5-116X	39400	Universal Joint	Alfa, Fiat, Ford, RVI, Saviem,Volvo	47,62 mm
5-11X	39100	Universal Joint	Alfa, Buick, Jeep, Mitsubishi,Rover, VW, Volvo	26,97 mm
5-120X	39100	Universal Joint	Alfa, Buick, Jeep, Mitsubishi,Rover, VW, Volvo	26,97 mm
5-121X	39100	Universal Joint	Alfa, Buick, Jeep, Mitsubishi,Rover, VW, Volvo	26,97 mm
5-12X	39100	Universal Joint	Alfa, Buick, Jeep, Mitsubishi,Rover, VW, Volvo	26,97 mm
5-13X	39100	Universal Joint	Alfa, Buick, Jeep, Mitsubishi,Rover, VW, Volvo	26,97 mm
5-143X	39220	Universal Joint	Dodge, Ferrari, Maserati, Pontiac	30,15 mm
5-1506X	39730	Universal Joint	Mercedes Benz	38,00 mm
5-1519X	39753	Universal Joint	Mercedes Benz	45,00 mm
5-16X	39400	Universal Joint	Alfa, Fiat, Ford, RVI, Saviem,Volvo	47,62 mm
5-174X	39220	Universal Joint	Dodge, Ferrari, Maserati, Pontiac	30,15 mm
5-178X	39220	Universal Joint	Dodge, Ferrari, Maserati, Pontiac	30,15 mm
5-18X	39220	Universal Joint	Dodge, Ferrari, Maserati, Pontiac	30,15 mm
5-21X	39100	Universal Joint	Alfa, Buick, Jeep, Mitsubishi,Rover, VW, Volvo	26,97 mm
5-279-2X	39400	Universal Joint	Alfa, Fiat, Ford, RVI, Saviem, Volvo	47,62 mm
5-279X	39400	Universal Joint	Alfa, Fiat, Ford, RVI, Saviem,Volvo	47,62 mm
5-281-4X	39958	Universal Joint	Seddon Atkinson	49,20 mm
5-281X	39958	Universal Joint	Seddon Atkinson	49,20 mm
5-438X	39429	Universal Joint		47,62 mm
5-480X	39220	Universal Joint	Dodge, Ferrari, Maserati, Pontiac	30,15 mm
5-4X	39110	Universal Joint	Berliet, Ferrari, Fiat, Renault, Rover, VW, Volvo	26,97 mm
5-5X	39100	Universal Joint	Alfa, Buick, Jeep, Mitsubishi, Rover, VW, Volvo	26,97 mm
5-617X	39220	Universal Joint	Dodge, Ferrari, Maserati, Pontiac	30,15 mm
5-627X	39220	Universal Joint	Dodge, Ferrari, Maserati, Pontiac	30,15 mm
5-63X	39100	Universal Joint	Alfa, Buick, Jeep, Mitsubishi, Rover, VW, Volvo	26,97 mm
5-674X	39429	Universal Joint		47,62 mm
5-6X	39100	Universal Joint	Alfa, Buick, Jeep, Mitsubishi, Rover, VW, Volvo	26,97 mm
5-71X	39100	Universal Joint	Alfa, Buick, Jeep, Mitsubishi, Rover, VW, Volvo	26,97 mm
5-78X	39220	Universal Joint	Dodge, Ferrari, Maserati, Pontiac	30,15 mm
5-7X	39220	Universal Joint	Dodge, Ferrari, Maserati, Pontiac	30,15 mm
5-94X	39110	Universal Joint	Berliet, Ferrari, Fiat, Renault, Rover, VW, Volvo	26,97 mm
5-9X	39220	Universal Joint	Dodge, Ferrari, Maserati, Pontiac	30,15 mm

**VERGLEICHSNUMMERN
CROSS-REFERENCES
TRW - SM**

TRW cross-ref.	SM ref.:	Product Cat.	Manufacturer Type	Measurement D
20023	39110	Universal Joint	Berliet, Ferrari, Fiat, Renault, Rover, VW, Volvo	26,97 mm
20024	39100	Universal Joint	Alfa, Buick, Jeep, Mitsubishi, Rover, VW, Volvo	26,97 mm
20054	39220	Universal Joint	Dodge, Ferrari, Maserati, Pontiac	30,15 mm
20104	39400	Universal Joint	Alfa, Fiat, Ford, RVI, Saviem, Volvo	47,62 mm
20132	39958	Universal Joint	Seddon Atkinson	49,20 mm
20134	39400	Universal Joint	Alfa, Fiat, Ford, RVI, Saviem, Volvo	47,62 mm
20137	39958	Universal Joint	Seddon Atkinson	49,20 mm
20140	39220	Universal Joint	Dodge, Ferrari, Maserati, Pontiac	30,15 mm
20190	39220	Universal Joint	Dodge, Ferrari, Maserati, Pontiac	30,15 mm
20296	39753	Universal Joint	Mercedes Benz	45,00 mm
20337	39220	Universal Joint	Dodge, Ferrari, Maserati, Pontiac	30,15 mm
20347	39429	Universal Joint		47,62 mm
20417	39730	Universal Joint	Mercedes Benz	38,00 mm

**VERGLEICHSNUMMERN
CROSS-REFERENCES
UC - SM**

UC cross-ref.	SM ref.:	Product Cat.	Manufacturer Type	Measurement D
10054	39948	Universal Joint	Scania	48,00 mm
10056	39954	Universal Joint	Scania	57,00 mm
10059	39747	Universal Joint	Mercedes Benz	42,00 mm
10061	39388	Universal Joint	Scania	50,00 mm
10062	39384	Universal Joint	Scania	44,00 mm
10076	39381	Universal Joint	Scania	50,00 mm
10101	39100	Universal Joint	Alfa, Buick, Jeep, Mitsubishi, Rover, VW, Volvo	26,97 mm
12840	39756	Universal Joint	DAF, Mercedes Benz, Fiat, RVI, Steyr	52,00 mm
13070	39813	Universal Joint	DAF, Fiat, Deutz, MAN, RVI, Steyr	57,00 mm
13140	39763	Universal Joint	MAN, Mercedes Benz	57,00 mm
13598	39765	Universal Joint	Fiat, Mercedes Benz	48,00 mm
13840	39958	Universal Joint	Seddon Atkinson	49,20 mm
13872	39110	Universal Joint	Berliet, Ferrari, Fiat, Renault, Rover, VW, Volvo	26,97 mm
14157	39767	Universal Joint	DAF, Fiat, MAN, RVI, Steyr	48,00 mm
14186	39982	Universal Joint	DAF, Fiat, Mercedes Benz	65,00 mm
14974	39949	Universal Joint	Scania	57,00 mm
15192	39429	Universal Joint		47,62 mm
16139	39990	Universal Joint	Volvo	57,00 mm
17033	39909	Universal Joint	DAF, Fiat, MAN	52,00 mm
17173	39325	Universal Joint	Mercedes Benz	31,00 mm
18100	39100	Universal Joint	Alfa, Buick, Jeep, Mitsubishi, Rover, VW, Volvo	26,97 mm
18110	39110	Universal Joint	Berliet, Ferrari, Fiat, Renault, Rover, VW, Volvo	26,97 mm
18154	39462	Universal Joint	Mercedes Benz	68,00 mm
18178	39178	Universal Joint	VW	27,00 mm
18220	39220	Universal Joint	Dodge, Ferrari, Maserati, Pontiac	30,15 mm
18244	39948	Universal Joint	Scania	48,00 mm
18350	39350	Universal Joint	Alfa, DAF, Fiat, Ford, RVI, Scania, Volvo	39,63 mm
18380	39380	Universal Joint	Volvo	44,00 mm
18400	39400	Universal Joint	Alfa, Fiat, Ford, RVI, Saviem, Volvo	47,62 mm
18687	39924	Universal Joint	Scania	65,00 mm
18725	397284	Universal Joint	Mercedes Benz	24,06 mm
18730	39730	Universal Joint	Mercedes Benz	38,00 mm
19394	39753	Universal Joint	Mercedes Benz	45,00 mm

KUPPLUNGSUSRÜCKLAGER

CLUTCH RELEASE BEARINGS WITH SUPPORT

ROULEMENT D'EMBAYAGE AVEC SUPPORT

RODAMIENTOS DE EMBRAGUE CON SOPORTE

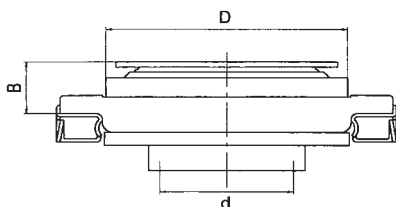

SM Ref.: 381010C

Cross Ref.:

3151 193 041
500 0172 11
13734
RDC 1010 AC



D
62,50

B
12,00

d
34,05

APPLICATION

OE Ref.:

AUDI

Car

80 (80, 82, B1)	019 141 165
80 (81, 85, B2)	088 141 165
90 (81, 85, B29)	088 141 165 A
100 (C1)	088 141 165 B
100 Coupe (C1)	088 141 165 C
100 (43, C2)	091 141 165
100 Avant (43, C2)	091 141 165 A
100 (44, 44Q, C3)	091 141 165 B
100 Avant (44, 44Q, C3)	091 141 165 D
200 (43)	113 141 165
200 (44, 44Q)	113 141 165 A
200 Avant (44, 44Q)	113 141 165 B
4000	113 141 165 C
COUPE (81, 85)	113 141 165 D
FOX	

IKARUS

100 - 542	
521 (VW)	

PORSCHE

924	019 141 165
	113 141 165 B

VW

181	019 141 165
1500, 1600 (31)	088 141 165
1500,1600 Hatchback (31)	088 141 165 A
1500,1600 Variant (36)	088 141 165 B
DASHER	088 141 165 C
GOL	091 141 165
KAEFER	091 141 165 A
KAEFER Convertible (15)	091 141 165 B
KARMANN GHIA Coupe (14, 34)	091 141 165 D
KARMANN GHIA Convertible (14, 34)	113 141 165
LT 28-35 I Bus (281-363)	113 141 165 A
LT 28-35 I Box (281-363)	113 141 165 B
LT 28-35 I Flatbed/Chassis (281-363)	113 141 165 C
LT 40-55 I Box (291-512)	113 141 165 D
LT 40-55 I Flatbed/Chassis (293-909)	
PARATI KOMBI	
PASSAT (32)	
PASSAT Variant (33)	
PASSAT (32B)	
PASSAT Saloon (32B)	
PASSAT Variant (32B)	
POINTER	
POINTER Variant	
POINTER Pickup	
QUANTUM	
SANTANA (32B)	
SAVEIRO Pick Up	

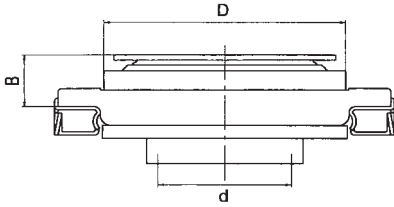

SM Ref.: 381010C

Cross Ref.:

3151 193 041
500 0172 11
13734
RDC 1010 AC



D	B	d
62,50	12,00	34,05

APPLICATION

OE Ref.:

VW

TRANSPORTER T2 Bus
TRANSPORTER T2 Box
TRANSPORTER T2 Flatbed/Chassis
TRANSPORTER T3 Box
TRANSPORTER T3 Flatbed/Chassis

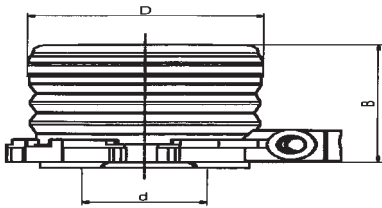

SM Ref.: 381506

Cross Ref.:

3182 998 803
510 0073 10
510 0053 10
RDH 1506



D	B	d
67,90	59,60	19,90

APPLICATION

OE Ref.:

ALFA ROMEO

159
159 Sportwagon

FIAT

CROMA (194)

71747899
24422061

OPEL

ASTRA G Hatchback (F48_, F08_)
ASTRA G Estate (F35_)
ASTRA G Saloon (F69_)
ASTRA G Box (F70)
ASTRA G Coupe (F07_)
ASTRA G Convertible
ASTRA H
ASTRA H Estate
ASTRA H GTC
ASTRA H TwinTop
ASTRA H Saloon
ASTRA J
ASTRA Sports Tourer (J)
COMBO Box Body / Estate
COMBO Tour
CORSA C (F08, F68)
CORSA C Box (F08, W5L)
CORSA D
MERIVA
MERIVA B
SIGNUM
TIGRA TwinTop
VECTRA B (36_)

24 422 061
24 424 957
5 679 304
5 679 332
5 679 333
679 344
90 470 874
90 523 765
93 317 724

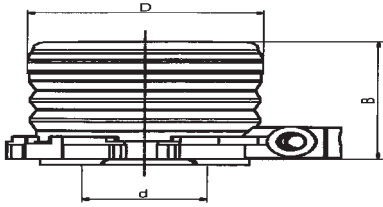

SM Ref.: 381506

Cross Ref.:

3182 998 803
 510 0073 10
 510 0053 10
 RDH 1506



D	B	d
67,90	59,60	19,90

APPLICATION		OE Ref.:
OPEL	VECTRA B Hatchback (38_) VECTRA B Estate (31_) VECTRA C VECTRA C GTS VECTRA C Estate ZAFIRA (F75_) ZAFIRA (A05)	
SAAB	9-3 (YS3F) 9-3 Estate	24422061
SUZUKI	SWIFT III (SG)	23820-63JA0
VAUXHALL	ASTRA Mk IV (G) ASTRA Mk IV (G) Hatchback ASTRA Mk IV (G) Convertible ASTRA Mk IV (G) Coupe ASTRA Mk IV (G) Estate ASTRAVAN Mk IV (G) ASTRA Mk V (H) Hatchback ASTRA Mk V (H) Estate ASTRA Mk V (H) Sport Hatch ASTRA TwinTop Mk V (H) COMBO Mk II (C) (F25) CORSA Mk III (C) (W5L, F08) CORSAVAN Mk III (C) CORSA Mk IV (D) (L_8) MERIVA Mk I (A) TIGRA TwinTop VECTRA (B) VECTRA (B) Hatchback VECTRA (B) Estate VECTRA Mk II (C) VECTRA Mk II (C) GTS VECTRA Mk II (C) Estate ZAFIRA Mk I (A) (F75) ZAFIRA Mk II (B) (M75)	24422061 56 79 333

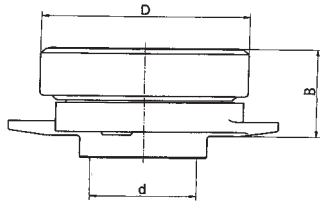

SM Ref.: 381312

Cross Ref.:

3151 095 043
 500 0257 10
 500 0257 20
 RDL 1312



D	B	d
81,60	41,00	42,20

APPLICATION

OE Ref.:

MERCEDES BENZ

T2/L Dumptruck	312 250 1315
T2/L Box Body / Estate	340 250 0215
T2/L Flatbed / Chassis	345 250 0215
T2/L Truck Tractor	352 250 0115
T2/L General Purpose Vehicle	352 250 0515
322	
408	
508	
608	
709	
808 / 809 / 811 / 813	
911 / 913	
1013	
1113	
1213	
1313	
1413	
1513	
1813	
O 302	
O 309	
O 608	
O 709	
OF Series	

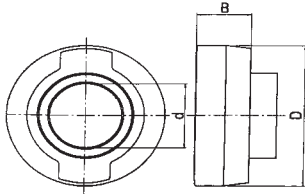

SM Ref.: 381305

Cross Ref.:

3151 044 031

500 0173 10

RDL 1305 AC



D	B	d
92,00	31,50	42,20

APPLICATION

OE Ref.:

MERCEDES - BENZ

T2/L Dumptruck	000 250 4215
T2/L Box Body / Estate	000 250 4615
T2/L Flatbed / Chassis	001 250 9115
408	001 250 9315
508	381 250 0415
608 / 613	
709	
808 / 809	
811 / 813 / 814 / 817	
913 / 914 / 917	
1013 / 1017	
1113 / 1114 / 1117	
1213 / 1214 / 1216 / 1217	
1314 / 1317 / 1320	
1413 / 1414 / 1417 / 1420	
1514 / 1517	
1613 / 1614 / 1617	
1814 / 1817	
2227	
O 301	
O 309	
O 402	
O 608	
O 709	
O 814	
O 817	
O 914	
O 1114	

NEOPLAN

Clubstar
N 906 - N 940

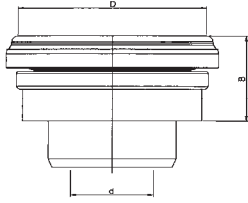

SM Ref.: 381397

Cross Ref.:

3151 261 031
3151 000 396
500 0806 20
RDL 1397



D
100,00

B
52,00

d
50,50

APPLICATION

OE Ref.:

MERCEDES - BENZ

ATEGO 712 - 717
ATEGO 812 - 830
ATEGO 914 - 930
ATEGO 1014 - 1118
ATEGO 1214 - 1229
ATEGO 1315 - 1419
ATEGO 1517 - 1728
ATEGO 1823 - 1929
ATEGO 2223 - 2530
ATEGO 2628 -
AXOR 2523 - 2543
AXOR 2623 - 2831
Unimog 100-500
VARIO
VARIO Bus
VARIO Box Body / Estate
VARIO Flatbed / Chassis
VARIO Dumptruck
VARIO Cab with engine
O 510 (TOURINO)
O 812
O 814
O 815

001 250 9915
002 250 0015
002 250 6515

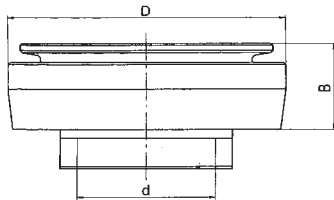

SM Ref.: 381320

Cross Ref.:

3151 272 631
500 0573 21
RDL 1320 AC



D
110,00

B
40,00

d
54,60

APPLICATION

OE Ref.:

MERCEDES - BENZ

811 / 814 / 817
917
1117 / 1120 / 1121 / 1124
1224
1314 / 1317 / 1320 / 1324
1417 / 1419 / 1420
1517 / 1520 / 1524
1617 / 1619 / 1620
1717 / 1720 / 1724
1820
2020 / 2024
2219 / 2220
2420

001 250 2215

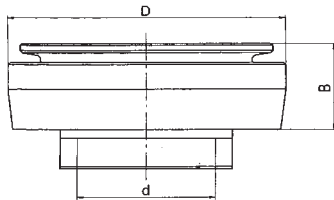

SM Ref.: 381320

Cross Ref.:

3151 272 631

500 0573 21

RDL 1320 AC



D	B	d
110,00	40,00	54,60

APPLICATION

OE Ref.:

MERCEDES - BENZ

O 817
O 1117
O 1120
OH - Series

IVECO

7138964

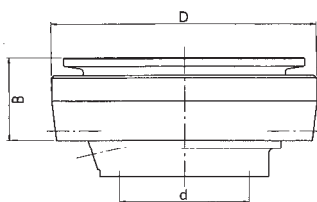

SM Ref.: 381328

Cross Ref.:

3151 112 031

500 0314 20

RDL 1328



D	B	d
110,00	39,90	54,20

APPLICATION

OE Ref.:

MERCEDES - BENZ

817
1117 / 1120 / 1121 / 1124
1317 / 1320
1417 / 1419 / 1420
1517 / 1524
1617 / 1619 / 1620
1720
2020
2219
2220
O 1117
O 1120
OH - Series

000 250 7015

NEOPLAN

0401.197.00

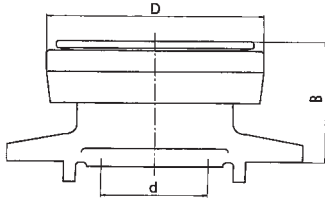

SM Ref.: 381307

Cross Ref.:

3151 027 131
 3151 000 375
 500 0109 10
 500 0109 20
 RDL 1307 AC



D	B	d
110,00	71,00	54,20

APPLICATION		OE Ref.:
HANOMAG HENSCHEL		
F 150 - F 420		000 250 18 15 000 250 19 15
LIEBHERR		
Crane		
FAUN		
		0890 591
MERCEDES BENZ		
1019		000 250 1815
1222 / 1225 / 1228		000 250 1915
1422 / 1424 / 1425 / 1428		000 250 2515
1619 / 1622 / 1624 / 1625 / 1626 / 1628 / 1632		000 250 7415
1719		000 250 7715
1919 / 1922 / 1926 / 1928 / 1932		
2025 / 2026 / 2028 / 2032 / 2036		
2222 / 2224 / 2225 / 2226 / 2228 / 2232 / 2236		
2425 / 2428		
2626 / 2628 / 2632		
3025 / 3028		
3228		
3233 / 3235		
3328 / 3332 / 3335 / 3336		
3528 / 3535		
4445		
4645		
O 303		
O 305		
O 307		
O 405		
NEOPLAN		
N 133 - N 166		11000033
N 117 - N 120		
N 121 - N 128		
N 202 - N 209		
N 210 - N 213		
N 214 - N 216		
N 218 - N 220		
N 312 - N 314		
N 316 - N 318		
N 320 - N 326		
N 412 - N 416		

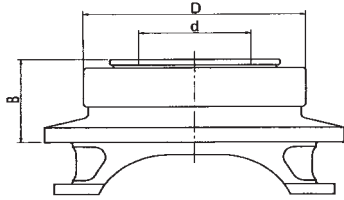

SM Ref.: 381316L

Cross Ref.:

3151 106 041
500 0318 20
RDL 1316



D	B	d
115,00	50,50	66,10

APPLICATION

OE Ref.:

VOLVO

F 7
F 10
F 12
F 88
F 89
FB - series
G - series
N 9
N 10
N 12

1527693
267156
352221

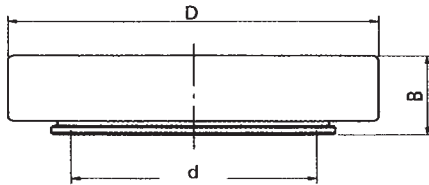

SM Ref.: 381316S

Cross Ref.:

RDS 1316

bearing



D	B	d
115,00	29,00	76,00

APPLICATION

OE Ref.:

VOLVO

1527696

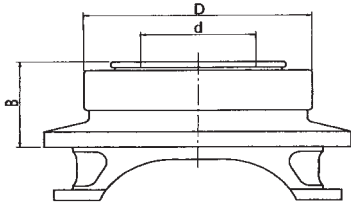

SM Ref.: 381318

Cross Ref.:

3151 824 002
 3151 600 533
 500 0610 20
 RDL 1318



D	B	d
115,00	54,30	58,20

APPLICATION		OE Ref.:
VOLVO		
B 7 B 10 B 51 - B 59 C 10 F 7 F 86 FB - series FE 6 FL 6 N 7 NB - series		1655288

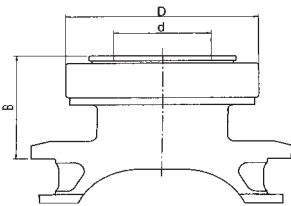

SM Ref.: 381322

Cross Ref.:

3151 105 141
 500 0271 20
 RDL 1322



D	B	d
115,00	72,00	66,10

APPLICATION		OE Ref.:
VOLVO		
B 51 - B 59 F 10 F 88 F 89 FB - series G - series N 10 N 88 NB - series		1527695 267158 348842 8112139

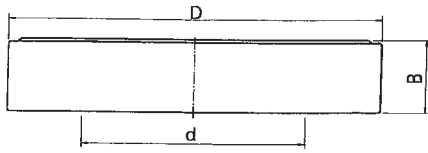

SM Ref.: 381015S

Cross Ref.:

1850 282 245
500 0427 20
RDS 1015



bearing

D	B	d
116,60	26,50	69,85

APPLICATION		OE Ref.:
SAAB		203825
SCANIA		133011
	65	203825
	75	215131
	76	
	80	
	81	
	85	
	86	
	110	
	111	
	Bus	

SM Ref.: 383901

Cross Ref.:

3151 000 151
500 1158 10



D	B	d
124,00	90,00	63,00

APPLICATION		OE Ref.:
SCANIA		1479576
	Bus K94 / L94 / N94 / 114 / 124	1499770
	4 - series	1728165
		1749125
		1851631
MAN		64.30500.001

SM Ref.: 385101

Cross Ref.:

3100 026 531

500 1071 20



D
124,00

B
111,00

d
66,50

APPLICATION

OE Ref.:

VOLVO

FH
FH 12
FM
FM 7
FM 12

20569155
3192220

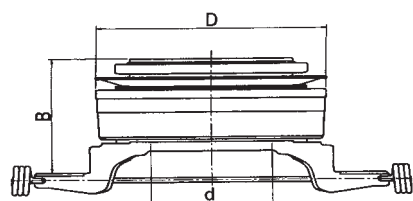

SM Ref.: 381319

Cross Ref.:

3100 026 432

500 0611 20

RDL 1319

with kit



D
126,60

B
74,00

d
66,80

APPLICATION

OE Ref.:

VOLVO

B 10
B 12
F 10
F 12
F 16
FH
FH 12
FH 16
FL 7
FL 10
FL 12
FM
FM 9
FM 12
N 10
N 12
NL 12 S
8500
8700
9700
9900

1655843
1668921
1669832
16698334
1672944
20569157
3192222
8112113A

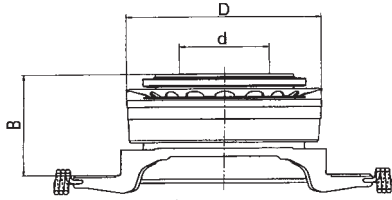

SM Ref.: 381325

Cross Ref.:

3100 002 220
 3100 026 433
 500 0608 20
 500 0608 21
 RDL 1325



D 126,60	B 86,50	d 66,80
--------------------	-------------------	-------------------

APPLICATION

OE Ref.:

VOLVO

B 10
 FL 7
 FL 10
 FS 7

1655732
 1655825
 1667258
 1668923
 1669833
 1672946
 20571928
 3192223
 8112159

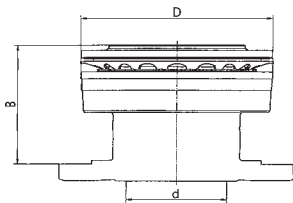

SM Ref.: 381329

Cross Ref.:

with kit

3100 008 101
 3100 008 201
 500 0872 20
 500 0872 10
 RDL 1329



D 126,60	B 91,50	d 60,80
--------------------	-------------------	-------------------

APPLICATION

OE Ref.:

SCANIA

Bus
 3 - series
 3 - series bus
 4 - series

1393161
 1407430
 1545062
 1321255
 1322781
 1319344

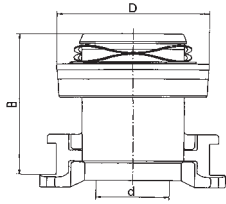

SM Ref.: 381332

Cross Ref.:

3151 246 031
 3151 000 278
 500 0666 10
 500 0666 20
 RDL 1332



D
126,60

B
137,00

d
60,80

APPLICATION

OE Ref.:

MERCEDES BENZ

1227 / 1234
 1424 / 1427 / 1431
 1729 / 1733 / 1735 / 1748
 1824 / 1827 / 1831 / 1834 / 1838 / 1844 / 1850 / 1853
 1929 / 1935 / 1948
 2024 / 2027 / 2031 / 2038 / 2044 / 2050
 2327
 2429 / 2431 / 2433 / 2435 / 2448
 2524 / 2527 / 2529 / 2531 / 2534 / 2535 / 2538 / 2544 / 2550 / 2553
 2629 / 2631 / 2634 / 2635 / 2637 / 2638 / 2644 / 2645 / 2648 / 2650 /
 2653
 3050 / 3053 / 3231 / 3233 / 3234 / 3235 / 3238 / 3244 / 3248 / 3250 /
 3253 / 3255
 3534 / 3535 / 3538 / 3544 / 3548 / 3550 / 3553
 4435
 4635 / 4644 / 4645 / 4648
 4844 / 4850 / 4853
 5035 / 5038
 5248
 O 345 (CONECTO)
 O 350 (TOURISMO)
 O 530 (CITARO)
 OH - series

001 250 0515
 001 250 4815
 001 250 6415
 001 250 6515
 001 250 7915
 001 250 8615
 001 250 9815

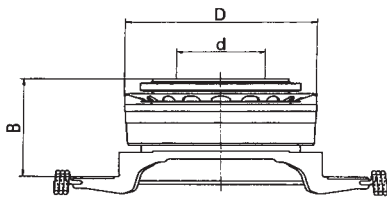

SM Ref.: 381352

Cross Ref.:

3100 002 549
 500 0784 20
 RDL 1352



D
126,60

B
77,00

d
58,50

APPLICATION

OE Ref.:

VOLVO

B 7
 B 10
 B 12
 FS 7

1668930
 1668938
 1669834
 1672948
 3192224

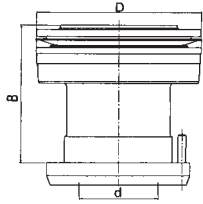

SM Ref.: 381356

Cross Ref.:

3100 002 255
500 0889 10
500 0889 20
RDL 1356



D 126,60	B 124,50	d 60,70
--------------------	--------------------	-------------------

APPLICATION

OE Ref.:

MERCEDES BENZ

ACTROS 1831 - 1861	002 250 4115
ACTROS 2031 - 2053	002 250 4715
ACTROS 2531 - 2557	002 250 6715
ACTROS 2631 - 2665	002 250 7815
ACTROS 3231 - 3339	002 250 8115
ACTROS 3340 - 3550	002 250 9815
ACTROS 4036 - 4841	
ATEGO 1823 - 1929	
ATEGO 2223 - 2530	
ATEGO 2628	
AXOR 1823 - 2044	
AXOR 2523 - 2543	
AXOR 2623 - 2831	
AXOR 3028 - 4144	
ECONIC	
Chassis O 500 RS / 1836	
Chassis O 500 RS / 2036	
Chassis O 500 RS / 2242	

SM Ref.: 381514

Cross Ref.:

3182 009 938
3182 009 936
510 0031 21



D -	B -	d -
---------------	---------------	---------------

APPLICATION

OE Ref.:

SCANIA

Bus K94 / L94 / N94 / 114 / 124	1123296
4 - series	1393332
	1434649
	1455730
	1522377

**Vergleichsnummern Liste
KUPPLUNGSUSRÜCKLAGER**

**Cross reference list
CLUTCH RELEASE BEARINGS WITH SUPPORT**

**Liste d'équivalences
ROULEMENT D'EMBAYAGE AVEC SUPPORT**

**Lista de intercambios
RODAMIENTOS DE EMBRAGUE CON SOPORTE**

**VERGLEICHSNUMMERN
CROSS-REFERENCES
LUK - SM**

LUK cross-ref.	SM ref.:	Product Cat.	Manufacturer Type	Measurement D
500010910	381307	Clutch release bearing with support	Mercedes Benz	110,00 mm
500010920	381307	Clutch release bearing with support	Mercedes Benz	110,00 mm
500017211	381010C	Clutch release bearing with support	VW / Audi	62,50 mm
500017310	381305	Clutch release bearing with support	Mercedes Benz	92,00 mm
500025710	381312	Clutch release bearing with support	Mercedes Benz	81,60 mm
500025720	381312	Clutch release bearing with support	Mercedes Benz	81,60 mm
500027120	381322	Clutch release bearing with support	Volvo	115,00 mm
500031420	381328	Clutch release bearing with support	Mercedes Benz	110,00 mm
500031820	381316L	Clutch release bearing with support	Volvo	115,00 mm
500042720	381015S	Bearing	Scania	116,60 mm
500057321	381320	Clutch release bearing with support	Mercedes Benz	110,00 mm
500060820	381325	Clutch release bearing with support	Volvo	126,60 mm
500060821	381325	Clutch release bearing with support	Volvo	126,60 mm
500061020	381318	Clutch release bearing with support	Volvo	115,00 mm
500061120	381319	Clutch release bearing with support with kit	Volvo	126,60 mm
500066610	381332	Clutch release bearing with support	Mercedes Benz	126,60 mm
500066620	381332	Clutch release bearing with support	Mercedes Benz	126,60 mm
500078420	381352	Clutch release bearing with support	Volvo	126,60 mm
500080620	381397	Clutch release bearing with support	Mercedes Benz	100,00 mm
500087210	381329	Clutch release bearing with support with kit	Scania	126,60 mm
500087220	381329	Clutch release bearing with support with kit	Scania	126,60 mm
500088910	381356	Clutch release bearing with support	Mercedes Benz	126,60 mm
500088920	381356	Clutch release bearing with support	Mercedes Benz	126,60 mm
500107120	385101	Clutch release bearing with support	Volvo	124,00 mm
500115810	383901	Clutch release bearing with support	Scania	124,00 mm
510003121	381514	Clutch release bearing with support	Scania	
510005310	381506	Clutch release bearing with support	Opel	67,90 mm
510007310	381506	Clutch release bearing with support	Opel	67,90 mm

**VERGLEICHSNUMMERN
CROSS-REFERENCES
NWO - SM**

NWO cross-ref.	SM ref.:	Product Cat.	Manufacturer Type	Measurement D
RDC 1010 AC	381010C	Clutch release bearing with support	VW / Audi	62,50 mm
RDH 1506	381506	Clutch release bearing with support	Opel	67,90 mm
RDL 1312	381312	Clutch release bearing with support	Mercedes Benz	81,60 mm
RDL 1320-AC	381320	Clutch release bearing with support	Mercedes Benz	110,00 mm
RDL 1397	381397	Clutch release bearing with support	Mercedes Benz	100,00 mm
RDL1305-AC	381305	Clutch release bearing with support	Mercedes Benz	92,00 mm
RDL1307-AC	381307	Clutch release bearing with support	Mercedes Benz	110,00 mm
RDL1316	381316L	Clutch release bearing with support	Volvo	115,00 mm
RDL1318	381318	Clutch release bearing with support	Volvo	115,00 mm
RDL1319	381319	Clutch release bearing with support with kit	Volvo	126,60 mm
RDL1322	381322	Clutch release bearing with support	Volvo	115,00 mm
RDL1325	381325	Clutch release bearing with support	Volvo	126,60 mm
RDL1328	381328	Clutch release bearing with support	Mercedes Benz	110,00 mm
RDL1329	381329	Clutch release bearing with support with kit	Scania	126,60 mm
RDL1332	381332	Clutch release bearing with support	Mercedes Benz	126,60 mm
RDL1352	381352	Clutch release bearing with support	Volvo	126,60 mm
RDL1356	381356	Clutch release bearing with support	Mercedes Benz	126,60 mm
RDS1015	381015S	Bearing	Scania	116,60 mm
RDS1316	381316S	Bearing	Volvo	115,00 mm

**VERGLEICHNUMMERN
CROSS-REFERENCES
OEM - SM**

OEM cross-ref.	SM ref.:	Product Cat.	Manufacturer Type	Measurement D
0890591	381307	Clutch release bearing with support	FAUN	110,00 mm
24422061	381506	Clutch release bearing with support	FIAT	67,90 mm
71747899	381506	Clutch release bearing with support	FIAT	67,90 mm
7138964	381320	Clutch release bearing with support	IVECO	110,00 mm
6430500001	383901	Clutch release bearing with support	MAN	
0002501815	381307	Clutch release bearing with support	Mercedes-Benz	110,00 mm
0002501915	381307	Clutch release bearing with support	Mercedes-Benz	110,00 mm
0002502515	381307	Clutch release bearing with support	Mercedes-Benz	110,00 mm
0002504215	381305	Clutch release bearing with support	Mercedes-Benz	92,00 mm
0002504615	381305	Clutch release bearing with support	Mercedes-Benz	92,00 mm
0002507015	381328	Clutch release bearing with support	Mercedes-Benz	110,00 mm
0002507415	381307	Clutch release bearing with support	Mercedes-Benz	110,00 mm
0002507715	381307	Clutch release bearing with support	Mercedes-Benz	110,00 mm
0012500515	381332	Clutch release bearing with support	Mercedes-Benz	126,60 mm
0012502215	381320	Clutch release bearing with support	Mercedes-Benz	110,00 mm
0012504815	381332	Clutch release bearing with support	Mercedes-Benz	126,60 mm
0012506415	381332	Clutch release bearing with support	Mercedes-Benz	126,60 mm
0012506515	381332	Clutch release bearing with support	Mercedes-Benz	126,60 mm
0012507915	381332	Clutch release bearing with support	Mercedes-Benz	126,60 mm
0012508615	381332	Clutch release bearing with support	Mercedes-Benz	126,60 mm
0012509115	381305	Clutch release bearing with support	Mercedes-Benz	92,00 mm
0012509315	381305	Clutch release bearing with support	Mercedes-Benz	92,00 mm
0012509815	381332	Clutch release bearing with support	Mercedes-Benz	126,60 mm
0012509915	381397	Clutch release bearing with support	Mercedes-Benz	100,00 mm
0022500015	381397	Clutch release bearing with support	Mercedes-Benz	100,00 mm
0022504115	381356	Clutch release bearing with support	Mercedes-Benz	126,60 mm
0022504715	381356	Clutch release bearing with support	Mercedes-Benz	126,60 mm
0022506515	381397	Clutch release bearing with support	Mercedes-Benz	100,00 mm
0022506715	381356	Clutch release bearing with support	Mercedes-Benz	126,60 mm
0022507815	381356	Clutch release bearing with support	Mercedes-Benz	126,60 mm
0022508115	381356	Clutch release bearing with support	Mercedes-Benz	126,60 mm
0022509815	381356	Clutch release bearing with support	Mercedes-Benz	126,60 mm
3122501315	381312	Clutch release bearing with support	Mercedes-Benz	81,60 mm
3402500215	381312	Clutch release bearing with support	Mercedes-Benz	81,60 mm
3452500215	381312	Clutch release bearing with support	Mercedes-Benz	81,60 mm
3522500115	381312	Clutch release bearing with support	Mercedes-Benz	81,60 mm
3522500515	381312	Clutch release bearing with support	Mercedes-Benz	81,60 mm
3812500415	381305	Clutch release bearing with support	Mercedes-Benz	92,00 mm
000.250.1915.C	381307	Clutch release bearing with support	Mercedes-Benz	110,00 mm
11000033	381307	Clutch release bearing with support	Neoplan	110,00 mm
040119700	381328	Clutch release bearing with support	Neoplan	110,00 mm
679344	381506	Clutch release bearing with support	Opel	67,90 mm
5679304	381506	Clutch release bearing with support	Opel	67,90 mm
5679332	381506	Clutch release bearing with support	Opel	67,90 mm
5679333	381506	Clutch release bearing with support	Opel	67,90 mm
24422061	381506	Clutch release bearing with support	Opel	67,90 mm
24424957	381506	Clutch release bearing with support	Opel	67,90 mm
90470874	381506	Clutch release bearing with support	Opel	67,90 mm
90523765	381506	Clutch release bearing with support	Opel	67,90 mm
93317724	381506	Clutch release bearing with support	Opel	67,90 mm
133011	381015S	Bearing	Scania	116,60 mm
203825	381015S	Bearing	Scania	116,60 mm
215131	381015S	Bearing	Scania	116,60 mm
1123296	381514	Clutch release bearing with support	Scania	
1319344	381329	Clutch release bearing with support with kit	Scania	126,60 mm
1321255	381329	Clutch release bearing with support with kit	Scania	126,60 mm
1322781	381329	Clutch release bearing with support with kit	Scania	126,60 mm
1393161	381329	Clutch release bearing with support with kit	Scania	126,60 mm

**VERGLEICHNUMMERN
CROSS-REFERENCES
OEM - SM**

OEM cross-ref.	SM ref.:	Product Cat.	Manufacturer Type	Measurement D
1393332	381514	Clutch release bearing with support	Scania	
1407430	381329	Clutch release bearing with support with kit	Scania	126,60 mm
1434649	381514	Clutch release bearing with support	Scania	
1455730	381514	Clutch release bearing with support	Scania	
1479576	383901	Clutch release bearing with support	Scania	
1499770	383901	Clutch release bearing with support	Scania	
1522377	381514	Clutch release bearing with support	Scania	
1545062	381329	Clutch release bearing with support with kit	Scania	126,60 mm
1728165	383901	Clutch release bearing with support	Scania	
1749125	383901	Clutch release bearing with support	Scania	
1851631	383901	Clutch release bearing with support	Scania	
23820-63JA0	381506	Clutch release bearing with support	Suzuki	67,90 mm
1672948	381352	Clutch release bearing with support	Volga	126,60 mm
16698334	381319	Clutch release bearing with support with kit	Volga	126,60 mm
019141165	381010C	Clutch release bearing with support	Volkswagen	62,50 mm
088141165	381010C	Clutch release bearing with support	Volkswagen	62,50 mm
091141165	381010C	Clutch release bearing with support	Volkswagen	62,50 mm
113141165	381010C	Clutch release bearing with support	Volkswagen	62,50 mm
088141165A	381010C	Clutch release bearing with support	Volkswagen	62,50 mm
088141165B	381010C	Clutch release bearing with support	Volkswagen	62,50 mm
088141165C	381010C	Clutch release bearing with support	Volkswagen	62,50 mm
091141165A	381010C	Clutch release bearing with support	Volkswagen	62,50 mm
091141165B	381010C	Clutch release bearing with support	Volkswagen	62,50 mm
091141165D	381010C	Clutch release bearing with support	Volkswagen	62,50 mm
113141165 B	381010C	Clutch release bearing with support	Volkswagen	62,50 mm
113141165 D	381010C	Clutch release bearing with support	Volkswagen	62,50 mm
113141165A	381010C	Clutch release bearing with support	Volkswagen	62,50 mm
113141165C	381010C	Clutch release bearing with support	Volkswagen	62,50 mm
267156	381316L	Clutch release bearing with support	Volvo	115,00 mm
267158	381322	Clutch release bearing with support	Volvo	115,00 mm
348842	381322	Clutch release bearing with support	Volvo	115,00 mm
352221	381316L	Clutch release bearing with support	Volvo	115,00 mm
1527693	381316L	Clutch release bearing with support	Volvo	115,00 mm
1527695	381322	Clutch release bearing with support	Volvo	115,00 mm
1527696	381316S	Bearing	Volvo	115,00 mm
1655288	381318	Clutch release bearing with support	Volvo	115,00 mm
1655732	381325	Clutch release bearing with support	Volvo	126,60 mm
1655825	381325	Clutch release bearing with support	Volvo	126,60 mm
1655843	381319	Clutch release bearing with support with kit	Volvo	126,60 mm
1667258	381325	Clutch release bearing with support	Volvo	126,60 mm
1668921	381319	Clutch release bearing with support with kit	Volvo	126,60 mm
1668923	381325	Clutch release bearing with support	Volvo	126,60 mm
1668930	381352	Clutch release bearing with support	Volvo	126,60 mm
1668938	381352	Clutch release bearing with support	Volvo	126,60 mm
1669832	381319	Clutch release bearing with support with kit	Volvo	126,60 mm
1669833	381325	Clutch release bearing with support	Volvo	126,60 mm
1669834	381352	Clutch release bearing with support	Volvo	126,60 mm
1672944	381319	Clutch release bearing with support with kit	Volvo	126,60 mm
1672946	381325	Clutch release bearing with support	Volvo	126,60 mm
3192220	385101	Clutch release bearing with support	Volvo	
3192222	381319	Clutch release bearing with support with kit	Volvo	126,60 mm
3192223	381325	Clutch release bearing with support	Volvo	126,60 mm
3192224	381352	Clutch release bearing with support	Volvo	126,60 mm
8112139	381322	Clutch release bearing with support	Volvo	115,00 mm
8112159	381325	Clutch release bearing with support	Volvo	126,60 mm
20569155	385101	Clutch release bearing with support	Volvo	
20569157	381319	Clutch release bearing with support with kit	Volvo	126,60 mm
20571928	381325	Clutch release bearing with support	Volvo	126,60 mm
8112113A	381319	Clutch release bearing with support with kit	Volvo	126,60 mm

**VERGLEICHSNUMMERN
CROSS-REFERENCES
SACHS - SM**

Sachs cross-ref.	SM ref.:	Product Cat.	Manufacturer Type	Measurement D
1850282245	381015S	Bearing	Scania	116,60 mm
3100000003	381001	Clutch release bearing with support	Mercedes Benz	
3100002220	381325	Clutch release bearing with support	Volvo	126,60 mm
3100002255	381356	Clutch release bearing with support	Mercedes Benz	126,60 mm
3100002549	381352	Clutch release bearing with support	Volvo	126,60 mm
3100008101	381329	Clutch release bearing with support with kit	Scania	126,60 mm
3100008201	381329	Clutch release bearing with support with kit	Scania	126,60 mm
3100026432	381319	Clutch release bearing with support with kit	Volvo	126,60 mm
3100026433	381325	Clutch release bearing with support	Volvo	126,60 mm
3100026531	385101	Clutch release bearing with support	Volvo	
3151000151	383901	Clutch release bearing with support	Scania	
3151000278	381332	Clutch release bearing with support	Mercedes Benz	126,60 mm
3151000375	381307	Clutch release bearing with support	Mercedes Benz	110,00 mm
3151000396	381397	Clutch release bearing with support	Mercedes Benz	100,00 mm
3151027131	381307	Clutch release bearing with support	Mercedes Benz	110,00 mm
3151044031	381305	Clutch release bearing with support	Mercedes Benz	92,00 mm
3151095043	381312	Clutch release bearing with support	Mercedes Benz	81,60 mm
3151105141	381322	Clutch release bearing with support	Volvo	115,00 mm
3151106041	381316L	Clutch release bearing with support	Volvo	115,00 mm
3151112031	381328	Clutch release bearing with support	Mercedes Benz	110,00 mm
3151193041	381010C	Clutch release bearing with support	VW / Audi	62,50 mm
3151246031	381332	Clutch release bearing with support	Mercedes Benz	126,60 mm
3151261031	381397	Clutch release bearing with support	Mercedes Benz	100,00 mm
3151272631	381320	Clutch release bearing with support	Mercedes Benz	110,00 mm
3151600533	381318	Clutch release bearing with support	Volvo	115,00 mm
3151824002	381318	Clutch release bearing with support	Volvo	115,00 mm
3182009936	381514	Clutch release bearing with support	Scania	
3182009938	381514	Clutch release bearing with support	Scania	
3182998803	381506	Clutch release bearing with support	Opel	67,90 mm